

BSW511 | FATHOM

Ø2-1/4" arm mount LED luminaire for outdoor locations, remote driver

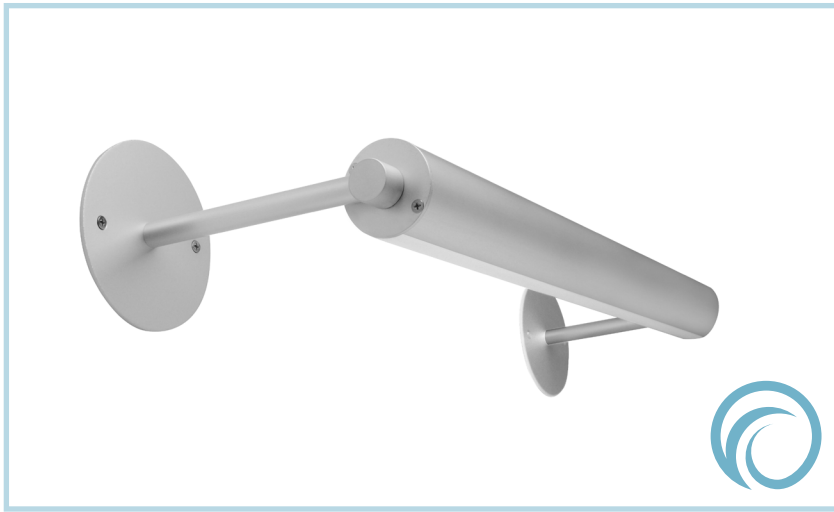

Project: _____ Type: _____



FEATURES

The BSW511 is a wet location, arm mounted LED luminaire, ideally suited for wall wash and facade lighting. Slender aluminum arms project the Ø2-1/4" extruded aluminum housing from a wall or ceiling. A frosted acrylic lens diffuses the light from high quality diodes, while a generous range of rotation allows for flexible aiming. Each fixture is paired with a remote mounted, wet location 0-10V dimming or non-dimming driver and housing.

SPECIFICATIONS

Fixture housing constructed of an extruded aluminum tube, frosted acrylic extruded lens and sheet aluminum end caps.

Fixture arms are constructed of zinc plated steel pipe Ø5/8" extruded aluminum sleeves and machined aluminum end cap couplers.

Mounting plate options include a Ø4-3/4" aluminum plate for mounting to 4" octagonal wall boxes or Ø1-3/8" aluminum plate for mounting to accessible panels.

Standard finishes as shown below.

Single and continuous run fixtures available with arm center distances of 2'-5' nominal.

Arms allow fixture to project from a wall or roofline nominally 4", 6", 12" or 18".

Fixture housing rotates 332° and is locked in place with hex fastener.

Included remote 120-277V wet location driver offered with 0-10V dimming or non-dim and surface mount aluminum enclosure.

Fixture wired with 10', low voltage leads (measured from the end cap).

Standard outputs are 640, 830 and 1090 lumens per foot.

LEDs available in 2700K, 3000K, 3500K, and 4000K, within a 3 step MacAdam ellipse, all with 90+ CRI typical.

Life: 50,000 hours L_{70} .

Limited five year warranty.

UL and C-UL listed for wet locations.



PROFILE

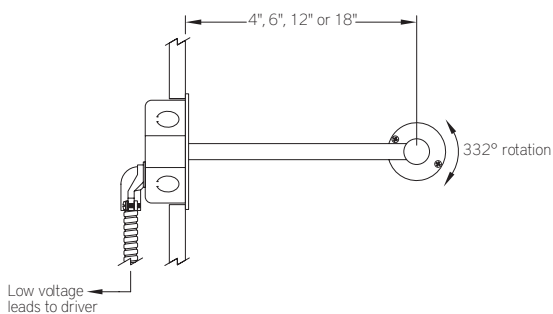

SECTION

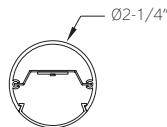

PERFORMANCE

Note: All data reflects fixtures with 3500K LEDs

NOMINAL LENGTH	OUTPUT	LUMENS/ft.	WATTS/ft.	LUMINAIRE LUMENS	EFFICACY (LPW)
4'	L: low	640	4.6	2366	138
	R: regular	830	7.6	3073	110
	H: high	1090	10.5	4038	104

BSW511 -

	-		-		-		-		-	
ARM CENTER DISTANCE		CORRELATED COLOR TEMPERATURE		DRIVER [remote] RN: non-dimming RD: 0-10V dimming, 5%		LIGHT OUTPUT (lumens per foot) L: low – 640 R: regular – 830 H: high – 1090 CF: consult factory for custom output		NOMINAL ARM LENGTH 4: 4” 6: 6” 12: 12” 18: 18” CF: consult factory for custom arm length		RUN CON- FIGURATION SN: single ST: starter AD: adder TR: terminator
2: 26” 3: 38” 4: 50” 5: 62”		27: 2700K-90+ CRI 30: 3000K-90+ CRI 35: 3500K-90+ CRI 40: 4000K-90+ CRI								FINISH AW: architectural white (semi-matte) WH: white (semi-gloss) BL: black (semi-matte) MB: matte black ESS: environmental satin silver BZ: bronze PR: primer CF: consult factory for custom finish
<div>MOUNTING PLATE OPTION</div> <div>WBR: wall box plate TP: trim plate</div>										

Note: Each fixture includes a remote driver

Note: Each fixture includes a remote driver matched for fixture length and light output.

MOUNTING

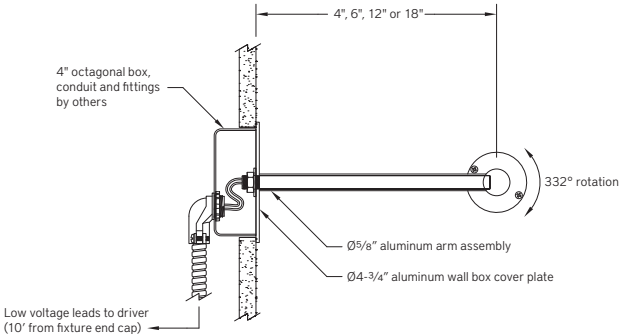
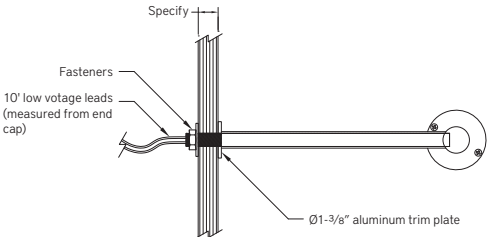
	ORDERING CODE	DESCRIPTION
	WBR	<p>WALL BOX MOUNTING PLATE</p> <ul style="list-style-type: none">• Ø4-3/4" x 1/8" sheet aluminum plate in matching finish for mounting to 4" octagonal junction box (by others)• Includes flat head Phillips machine screws
	TP	<p>TRIM PLATE</p> <ul style="list-style-type: none">• 1-3/8" x 1/8" sheet aluminum plate in matching finish for mounting to a panel with access to the back side• Includes 10' low voltage leads (measured from end cap), flat washer and hex nut• Accommodates panel thickness up to 3/4" – (consult factory for special mounting conditions)

EPA CALCULATIONS

EFFECTIVE PROJECTED AREA

LENGTH ORDER CODE	EPA
2	0.27 ft²
3	0.38 ft²
4	0.51 ft²
5	0.62 ft²

BSW511 | FATHOM

Ø2-1/4" arm mount LED luminaire for outdoor locations, remote driver



ARM CENTER DISTANCE

ORDERING CODE	LENGTH A
2	26"
3	38"
4	50"
5	62"

RUN CONFIGURATION INFORMATION

ORDERING CODE	DESCRIPTION
SN	Single
ST	Starter
AD	Adder
TR	Terminator

RUN INFORMATION

Single Fixtures

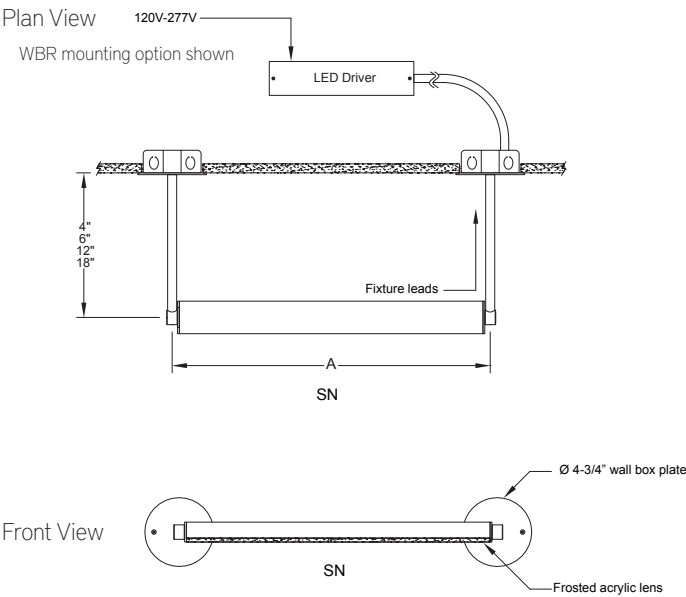

Continuous Runs

