



IMPORTANT - For your safety, read and understand instructions completely before installation. Luminaires must be installed by a qualified electrician (check with local and national codes for proper installation). Save these instructions for future reference.



WARNING - Risk of shock or fire. Disconnect power before installing Or servicing.

WARNING - Risk of shock or fire. LED installation requires knowledge of luminaires electrical systems. If not qualified, do not attempt installation. Contact a qualified electrician.

WARNING – Use only a with a Listed Class 2 Power Unit.

WARNING - To prevent wiring damage or abrasion, do not expose wiring to edges of sheet metal or other sharp objects.

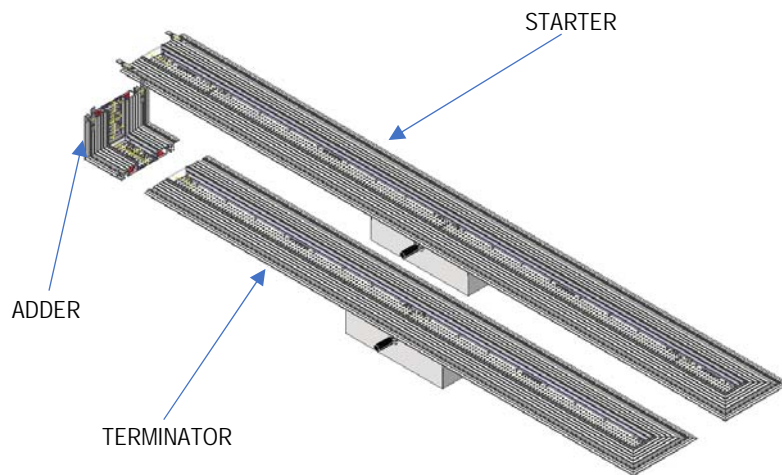

NOTE - Verify that all accessories are included in packaging. Components vary by model.

Installation Instructions:

1. Cut opening in wall 5-1/2" wide by proper length to t the selected Fixture. (to determine proper opening length, deduct 1" from the overall Fixture length)
2. Make small marks on wall to identify the centers of all the studs along the opening

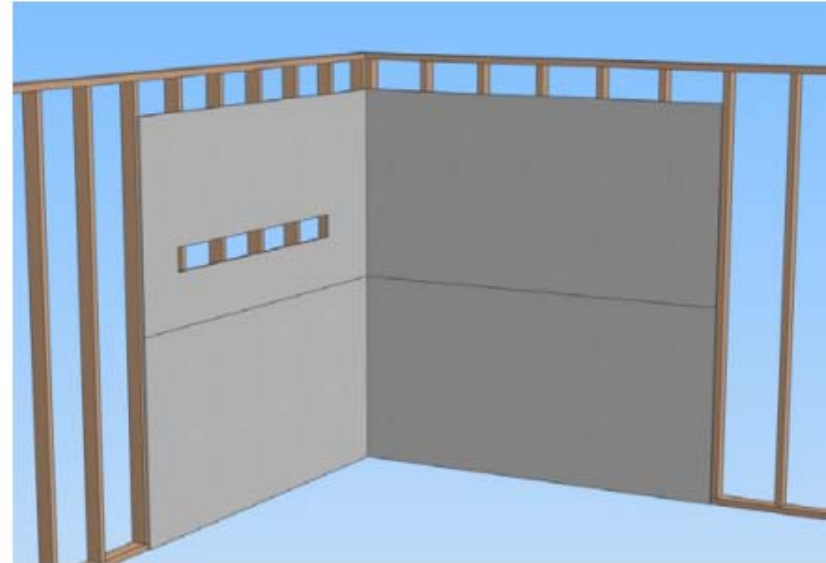

3. Remove lens from Fixture and set aside.
4. Remove the LED assembly by unscrewing the four Allen head screws located at each corner and set aside. Do not remove the hex nuts

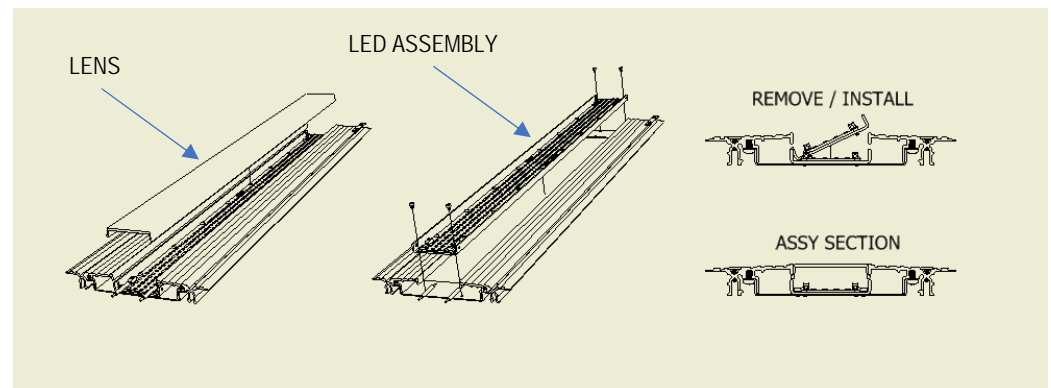

5. Insert Fixture housing into wall opening.

NOTE: If the center of a framing member is not within 4" from a Fixture end, install an additional piece of bracing (see vertical orientation recommendations).

6. If the driver box interferes with a wall stud, simply remove screws holding it in place and relocate .

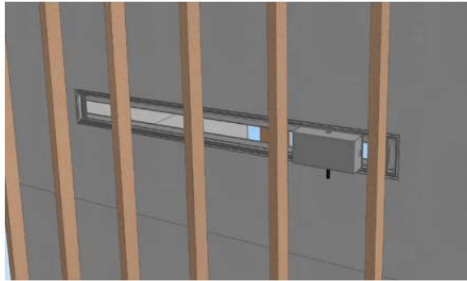

Driver box relocated to clear wall studs

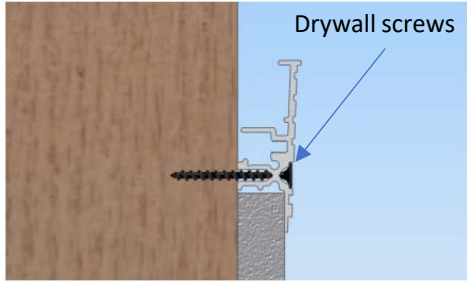

Drill holes through the mounting groove

FOR INSTALLING FIXTURE IN A VERTICAL ORIENTATION

New Construction: Install horizontal wall studs in 16" spacing in between the vertical studs

Existing Walls: Insert 2x4 wood studs through the wall opening in 16" spacing and rotate horizontally and secure to drywall with



New construction

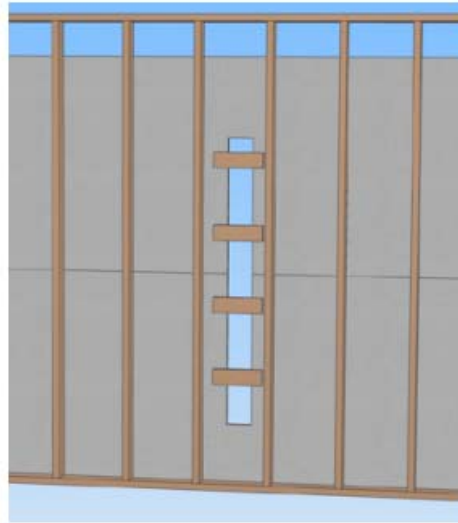

Existing wall

7. Once the Fixture is in the wall opening, transfer all the marks to the Fixture extrusion at the mounting groove. Drill 5/32" diameter holes through the mounting groove, in line with the marking locations.

8. Bring Fixture close to its Final location and make primary voltage electrical connection to the driver.

9. Secure Fixture to wall with drywall screws using the holes in the frame.

10. Bring LED assembly next to Fixture and make the low voltage electrical connection to the driver

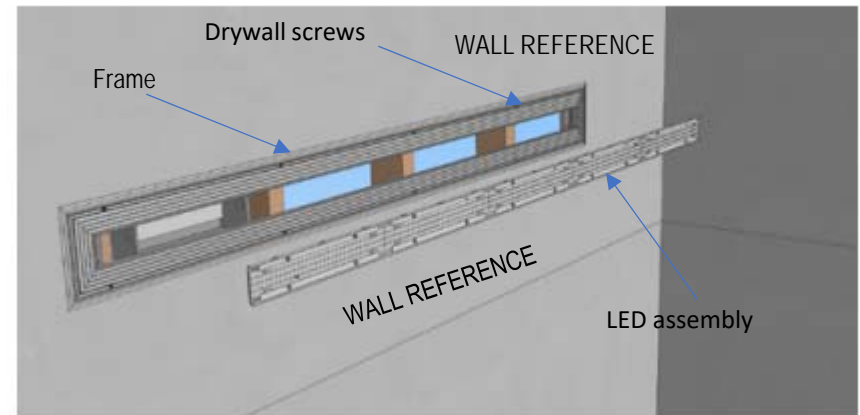

Mounted Fixture housing with LED assembly removed

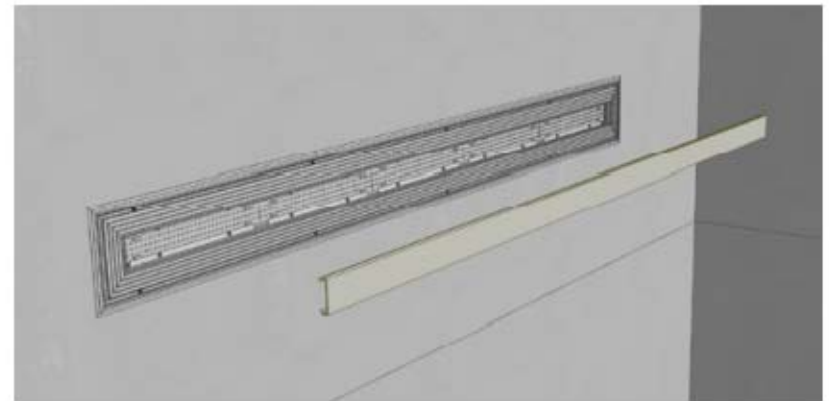

Mounted Fixture assembly with lens removed

11. Secure LED assembly with the four previously removed Allen head screws.

12. Test Fixture.

13. Protect lens with plastic or Painters tape and install into Fixture.

14. Affix Fiberglass mesh tape along the perimeter of Fixture.

15. Apply plaster in a manner to create a smooth transition from the Fixture aperture to the wall surface.

NOTE: For best use appearance, allow a minimum of 2-1/2" of wall surface beyond the Fixture edges.

16. Sand smooth, prime and paint.

17. Remove lens from Fixture and remove its protective material.

18. Reinstall lens.

19. Note: If you have a run configuration of stater, adder and terminator Bartco will provide aligning brackets

20. Repeat with all luminaires in a run, leveling each one as it is installed before continuing to the next.



Complete Fixture ready for plaster work

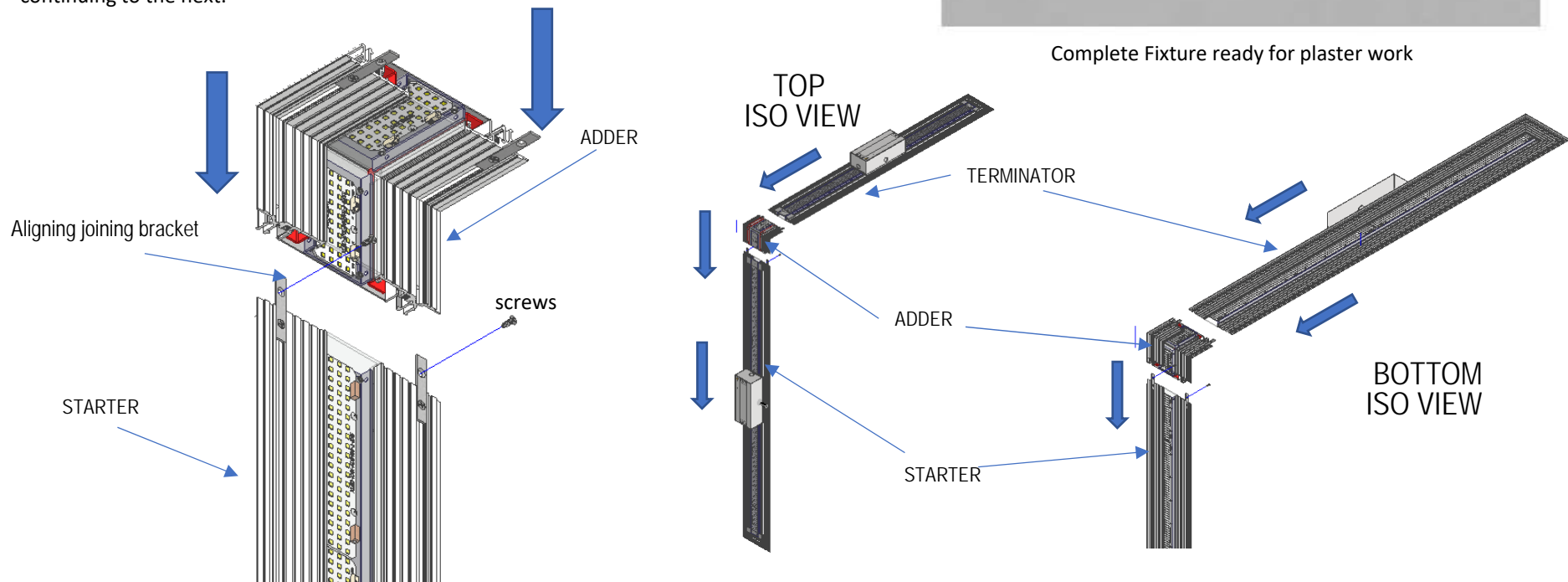

20. Prepare the cut opening in wall 5-1/2" wide by proper length to the selected Fixture. (to determine proper opening length, deduct 1" from the overall Fixture length)

22. Make small marks on wall to identify the centers of all the studs along the opening

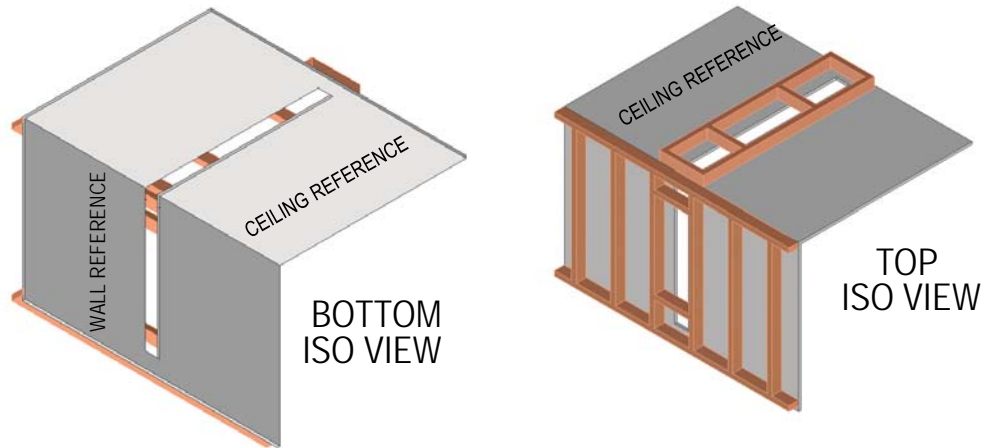

23. Install Starter fixture first, this one will be your guide to follow the run- just keep connecting the adder fixtures one after another (a chain connection)

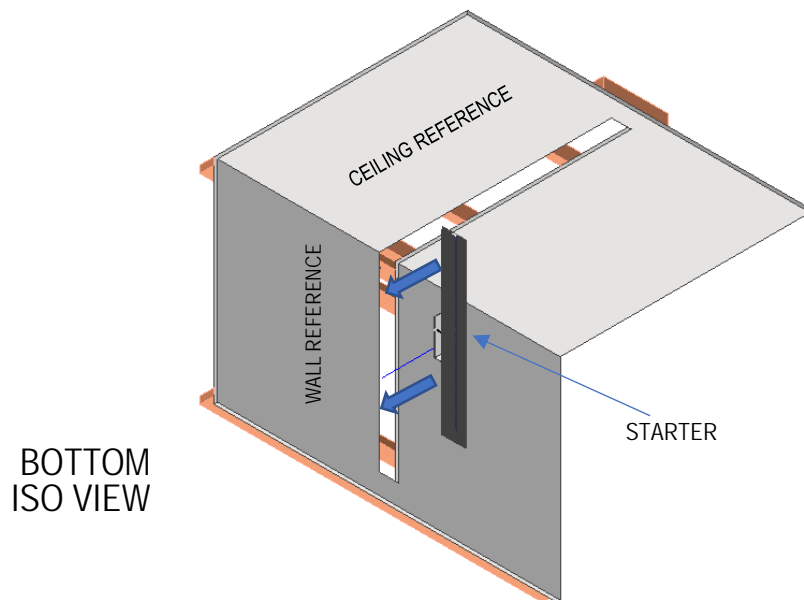

24. Run / connect power to the fixture before you secure to the ceiling or wall
25. Once you have secured the stater fixture continued . "Adder" fixtures you keep adding (in the middle).
26. Repeat with all luminaires in a run, leveling each one as it is installed before continuing to the next.

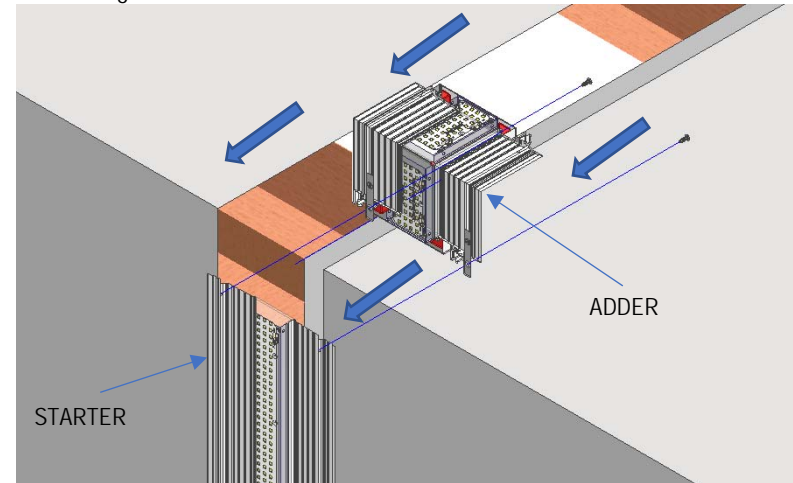

27. Once you have secured the stater fixture and adder fixture continued with the Terminator fixture; last fixture.

