

Installation Instructions

SK21 Run Configuration

Continuous Run with Hardwire Adapter and Screw Mount Spring Clips

b a r t c o
VISIONS BROUGHT TO LIGHT™

REV C-062618

SAFETY WARNINGS

- Disconnect the power source before installing or servicing fixtures. ELECTRICAL DAMAGE TO FIXTURES MAY OCCUR.
- To be installed by a qualified electrician only.
- All electrical installations should be made according to the national, State and Local codes and regulations.
- Risk of electric shock if not handled correctly

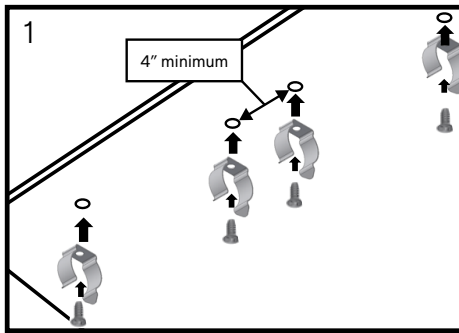

1. Install the Mounting Clips

Note: Each fixture is supplied with TWO spring mount clips.

- Secure all spring clips for the continuous run to the mounting surface using appropriate hardware (by others), through 5/32" diameter holes. The mounting clips require a 2" minimum spacing from the ends or 4" from each other.

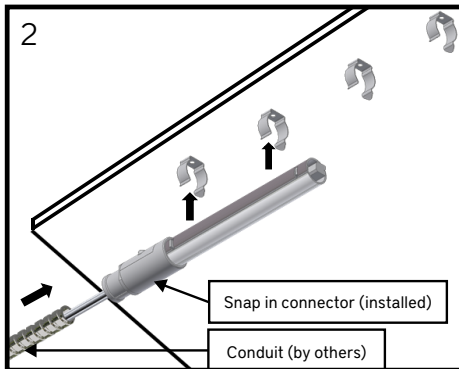

2. Install the Starter Fixture

- Starter Fixtures are provided with an installed Hardwire Conduit Adapter and 10' whip for 0-10V dimming or non-dimming control. Install appropriate conduit (by others) over the adapter leads and wire accordingly to the control.
- Snap the Starter fixture into the spring clips with the lens aimed at the desired angle.
- Apply power to the fixture and fine tune aiming of the light by rotating the fixture housing.

IMPORTANT: Disconnect power to the fixture before installing Adder fixtures or electrical damage may occur.

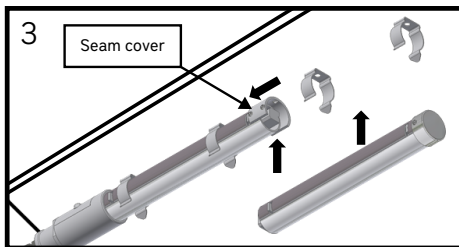

3. Install the Seam Cover(s)

Note: Each adder fixture is supplied with a loose Seam Cover.

- Slide the Seam Cover over the power output end of the Starter fixture.
- Leave the seam cover without tightening until adder fixture is installed.

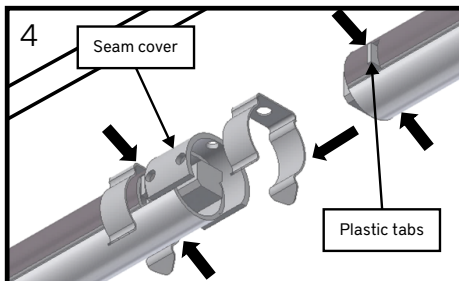

4. Install the Adder Fixture(s)

- Align the lens with the Starter fixture and snap the Adder fixture into the spring clips.
- While squeezing the two plastic tabs at the end of the fixtures, Slide the Adder fixture towards the Starter fixture and engage the power quick-connects fully.

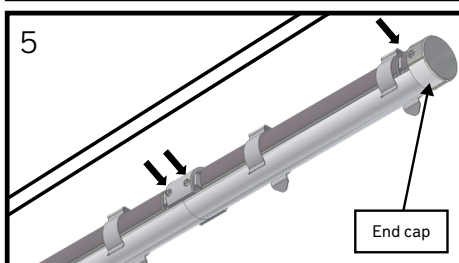

5. Install Seam Cover Screws

- Of the four set screws on the Seam Cover, tighten at least two set screws for each joined fixture using the provided 1/16" hex key wrench. Continue these steps for remaining Adder fixtures in the continuous run (up to 40' max length).
- On terminating fixture, place end cap and tighten set screw. **DO NOT OVERTIGHTEN SET SCREWS.**
- Apply power and test function. Installation is now complete.