

BLT205 | GENERAL INFORMATION

1-25/32" wide steel rectilinear LED fixture with drop down frosted lens

Project: _____ Type: _____



FEATURES

The BLT205 luminaire provides high performance with high value. The heavy gauge, sheet formed steel housing is offered in a rectangular or rounded profile with frosted acrylic lenses. Multiple driver, light output and mounting options enable this basic linear fixture to provide great versatility in applications.

SPECIFICATIONS

Housing is formed and welded, 20 ga. steel, chemically treated to resist corrosion and enhance paint adhesion

Model variations offered in rectangular or rounded profiles for surface and cable suspended applications

Standard finishes include Fluoroscope White (semi-matte), white (semi-gloss), black (semi-matte), matte black, silver, platinum*, bronze and primer powder coat, applied post production (consult factory for custom finishes)

Available as single fixtures in nominal lengths of 23"-89"

Knock-outs on back of surface mount model accept standard electrical fittings by others

Standard driver offered with 0-10V dimming or non-dim

Other dimming driver options available (refer to supplemental driver sheet for general information and consult factory for details)

Remote mounted emergency battery backup available (ordered separately, consult factory for details)

Standard light outputs are 5W or 8W nominal per foot

LEDs available in 3000K, 3500K, 4000K, 5000K, all with a typical 84-85 CRI and color consistency within a 3 step MacAdam ellipse

Options include end knock-outs and passive infrared occupancy sensor

Lamp life rated at 50,000 hours

Limited five year warranty

UL and C-UL listed for dry and damp locations

IBEW manufactured and assembled

Made in U.S.A.

SECTION

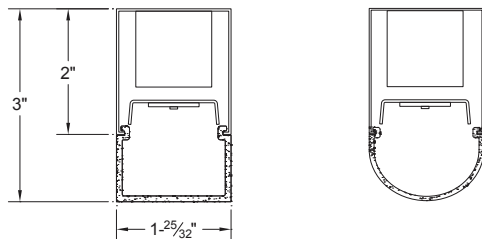

PLAN



SIDE

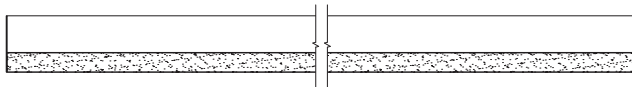

PERFORMANCE

NOMINAL LENGTH	WATTS/FT.	TOTAL WATTS	LUMINAIRE LUMENS	EFFICACY
45"	8.5	31.7	3629	114

*Note: All data reflects fixtures with 3500K LEDs

BLT205 +

FIXTURE LENGTH	COLOR TEMPERATURE	DRIVER	WATTS/FOOT	LENS	OPTIONS	MOUNT	FINISH
23: 22-1/4"	30: 3000K - 84 CRI	[Non-Dimming] leave blank for non-dimming	5: 5 W/ft.	leave blank for square lens	EK: add end knock-outs	SM: surface mount	FW: Fluoroscope white (semi-matte)
34: 33-1/4"	35: 3500K - 85 CRI	[Dimming] DIM: 0-10V	8: 8.5 W/ft.	R: round lens	S1: occ sensor pos.1 (see options page)	CM48: cable mount 48" cable length	WH: white (semi-gloss)
45: 44-1/4"	40: 4000K - 85 CRI	EHD: Lutron EcoSystem H-Series	CF: consult factory for custom wattage			CM96: cable mount 96" cable length	BL: black (semi-matte)
56: 55-1/4"	50: 5000K - 85 CRI	HLM: Lutron Hi-lume A-Series				CF: consult factory for custom mounting	MB: matte black
67: 66-1/4"							SL: silver
78: 77-1/4"							PT: platinum*
89: 88-1/4"							BZ: bronze
							PR: primer
							CF: consult factory for custom finish

* A standard finish requiring a 2 step coating process, premium will apply

OPTIONS

ORDERING CODE	DESCRIPTION	SPECIFICATIONS
EK	ADD END KNOCK OUTS	Ø 7/8" knock outs added at both fixture ends
	OCCUPANCY SENSOR	Passive infrared occupancy sensor with hold-off daylighting adjustment (10-120 foot candles) and time delay adjustment from 30 seconds to 30 minutes
S1	OCCUPANCY SENSOR - POSITION 1	Sensor located on the top at an end

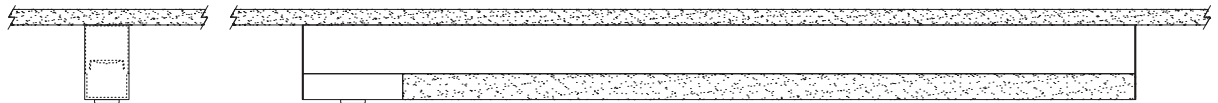
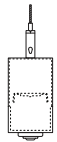

MOUNTING

	ORDERING CODE	DESCRIPTION
	SM	<p>SURFACE MOUNT</p> <p>Use appropriate fastener through Ø3/16" holes in housing</p>
	CM48 and CM96	<p>CABLE MOUNT</p> <p>Mounting option includes:</p> <ul style="list-style-type: none"> • Ø 1/16" x 48" (CM48) or 96" (CM96) aircraft cables • 18 gauge x 60" (CM48) or 108" (CM96) SJT power cable (in coordinating finish) • Bracket bars • Ø 5" white canopies • Ceiling couplers • Side exit cable grippers