

These instructions cover most instances of surface mounted Bartco fixtures, for both integral and remote driver operation.

1. Remove lens from fixture. Use flat tool to pry lens up from housing. Use caution to not overbend lens due to risk of cracking or deforming.

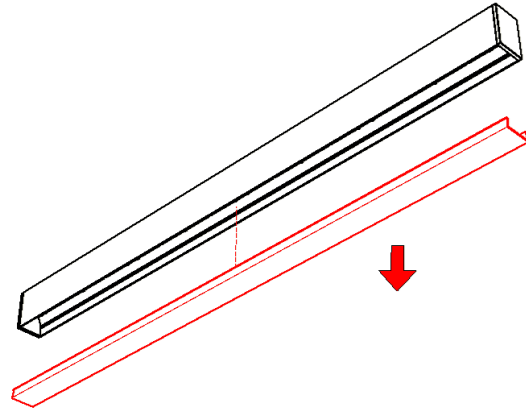
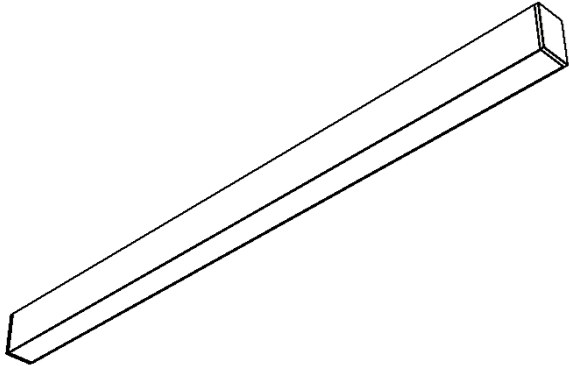

2. Remove LED liner assembly by pulling up to disengage from snap-in brackets. Set aside, or leave near fixture if pre-wired to integral driver.

3. Create necessary holes in mounting surface for power entry. Mount fixture to surface through back holes using fasteners by others.

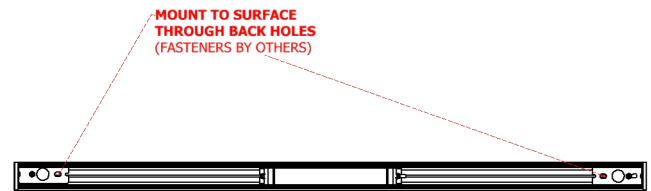
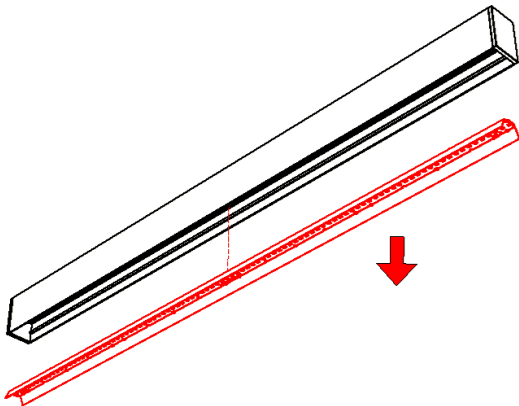

4. Wire fixture to power as explained below. After connections are confirmed, replace LED liner assembly by snapping back into brackets inside of housing.

5. Confirm fixture operates as intended, then replace lens by bending slightly to engage with fixture housing.

For remote driver operation, mount driver within 10' of fixture. Then run LED leads through power feed hole, and connect to driver.

For integral driver operation, driver wires will be pre-fed through hole. Simply connect to JBOX.

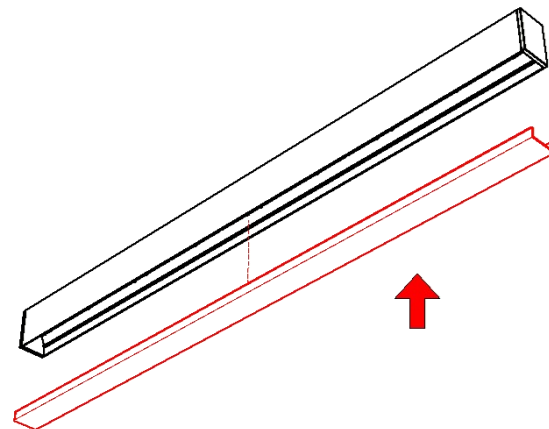
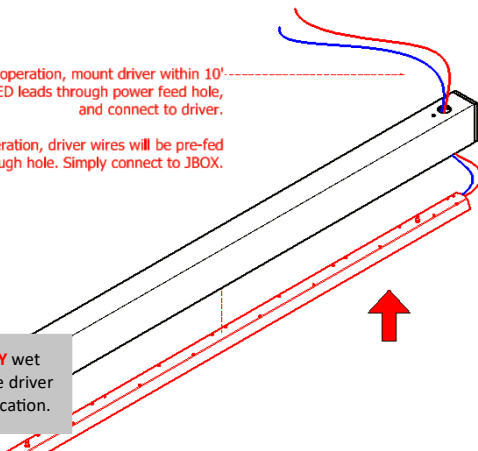

NOTE: For **EMERGENCY** wet listed fixtures, make sure driver box is mounted in dry location.

Warnings and Information ⚠️ ⚠️ ⚠️

- Risk of shock or fire. Disconnect power before installing or servicing.
- LED installation requires knowledge of luminaire electrical systems. If not qualified, do not attempt installation.
- To prevent wiring damage or abrasion, do not expose wiring to edges of sheet metal or other sharp objects.