

Type:

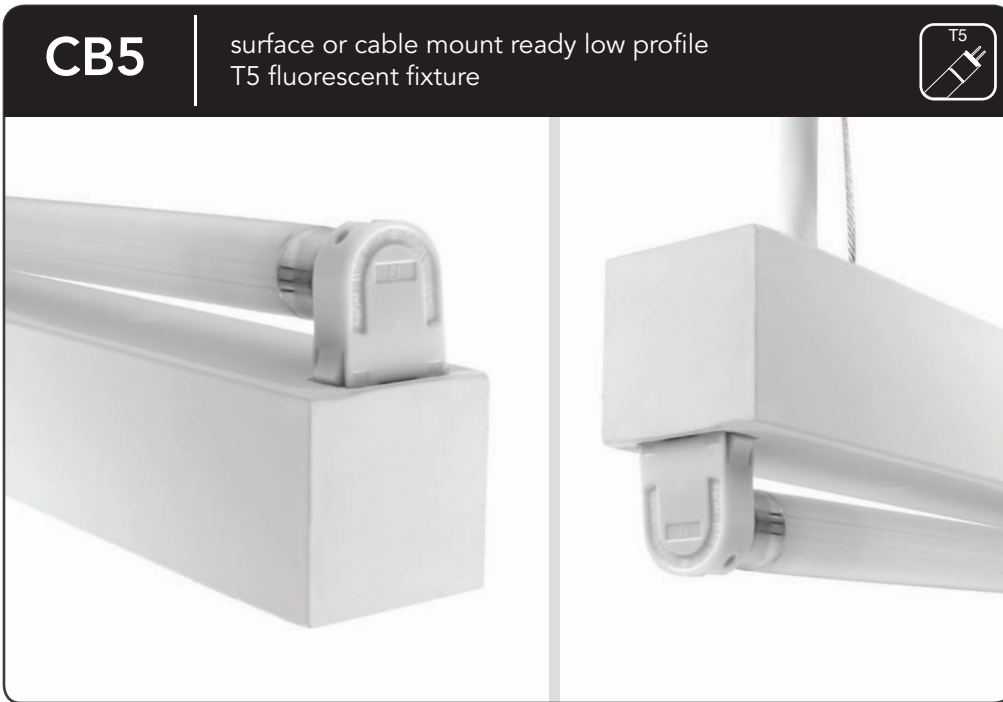

**CB5**

surface or cable mount ready low profile  
T5 fluorescent fixture



- Fully assembled housing is formed and welded, 20 ga. steel, chemically treated to resist corrosion and enhance paint adhesion
- Available in standard white, black, silver, platinum, bronze and primer powder coat, applied post production (consult factory for custom finishes)
- No visible knockouts
- Rotational locking lamp holders
- Available for one T5 14W, 21W, 28W, 35W and high output 24W, 39W, 54W, 80W linear fluorescent lamps
- Standard universal voltage (120-277V) PRS electronic high power factor ballast is pre-wired to the lamp holders (consult factory for other voltage options)
- For dimming and emergency battery back up options not listed below, consult factory for availability and system compatibility
- UL and ULC listed for dry and damp locations
- IBEW

WATTS

VOLTAGE

BALLAST

MOUNT

FINISH

CB5 +

- 14W: 22-1/2"
- 21W: 34-5/16"
- 28W: 46-1/16"
- 35W: 57-15/16"
- 24W: HO - 22-1/2"
- 39W: HO - 34-5/16"
- 54W: HO - 46-1/16"
- 80W: HO - 57-15/16"

+

- U: 120V-277V

+

- [Non-Dimming]
- PRS: program rapid start
- [Dimming]
- MKK: Advance Mark 10
- VII: Advance Mark 7
- H300: Lutron Hi-Lume 3D
- ESYS: Lutron EcoSystem
- ECO: Lutron Eco-10
- EHD: Lutron EcoSystem H
- DALI: Dali T5
- PHO: Sylvania Helios
- SD95-50: Universal BallaSTAR
- SD115-50: Universal BallaSTAR
- [Custom Performance]
- PH: 1.15BF program start
- PN85: 0.85BF program start
- PN90: 0.90BF program start
- PN95: 0.95BF program start
- [Emergency]
- I28: Iota ISL-28
- I54: Iota ISL-54
- I540: Iota ISL-540-35W
- L50: Bodine LP500
- L55: Bodine LP5500

+

- SM: surface mount
- CM48: cable mount 48" cable length
- CM96: cable mount 96" cable length
- PM18: pendant mount 18" stem length
- PM24: pendant mount 24" stem length
- PM30: pendant mount 30" stem length
- CF: consult factory for custom length

+

- WH: white
- BL: black
- SL: silver
- PT: platinum
- BZ: bronze
- PR: primer
- CF: consult factory for custom color

\*Not all ballasts work with all lamps. Consult factory for details.

Profile

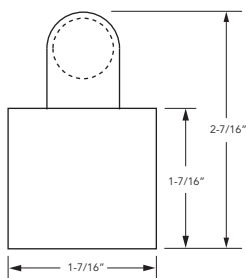

Top View

