

# BSS210 | GENERAL INFORMATION

Rectilinear LED fixture with drop down frosted lens

Project: \_\_\_\_\_ Type: \_\_\_\_\_

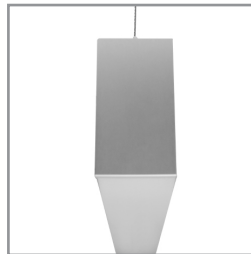

## FEATURES

The BSS210 is a linear LED luminaire for general illumination applications. The 2-1/8" wide extruded aluminum housing is capped by a 2" tall, frosted, three sided lens that produces a wide distribution of diffuse illumination. 1/4" thick machined aluminum ends caps finish off the fixture ends.

## SPECIFICATIONS

Fixture constructed of an extruded aluminum housing, frosted, extruded acrylic lens and machined aluminum end caps

Model variations offered for surface and cable suspended applications

Field adjustable cable hanger can be located at nearly any point along the fixture length

Standard finishes include satin anodize, or Fluorescape White (semi-matte), white (semi-gloss), black, silver, platinum, bronze and primer powder coat, applied post production (consult factory for custom finishes)

Available in nominal 23"-89" single fixtures and continuous runs

Continuous run models fitted with quick connects for simple, efficient wiring

Standard driver offered with 0-10V dimming or non-dim

Other dimming driver options available (refer to supplemental driver details sheet for availability)

Remote mounted emergency battery backup available (ordered separately, consult factory for details)

LEDs available in 3000K, 3500K, 4000K, 5000K, all with a typical CRI>80 and color consistency within a 3 step MacAdam ellipse

Lamp life rated at 50,000 hours

Limited three year warranty

UL and C-UL listed for dry and damp locations

IBEW manufactured and assembled

Made in U.S.A.

## SECTION

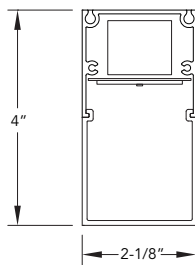

## PLAN

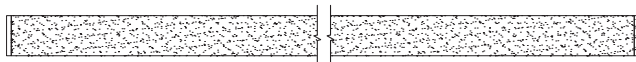

## SIDE

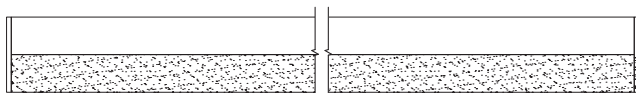

## PERFORMANCE

NOMINAL LENGTH	WATTS/ft.	TOTAL WATTS	LUMINAIRE LUMENS	EFFICACY
45"	5.0	18.8	2204	117
45"	8.5	31.8	3736	118

\*Note: All data reflects fixtures with 3500K LEDs

## BSS210 +

NOMINAL FIXTURE LENGTH	COLOR TEMPERATURE	DRIVER	WATTS/FOOT	MOUNT	RUN CONFIGURATION	FINISH
23: 22-5/8"	30: 3000K - 84 CRI	<b>[Non-Dimming]</b> leave blank for non-dimming	5: 5 W/ft.	SM: surface mount	SIN: single	SA: satin anodize
34: 33-5/8"	35: 3500K - 85 CRI	<b>[Dimming]</b> DIM: Advance 0-10V	8: 8.5 W/ft.	CM48: cable mount 48" cable length	STA: starter	FW: Fluorescape white (semi-matte)
45: 44-5/8"	40: 4000K - 85 CRI	ESYS: Lutron EcoSystem	CF: consult factory for custom wattage	CM96: cable mount 96" cable length	ADD: adder	WH: white (semi-gloss)
56: 55-5/8"	50: 5000K - 85 CRI	5-Series		CF: consult factory for custom mounting	TER: terminator	BL: black
67: 66-5/8"		HLM: Lutron Hi-lume				SL: silver
78: 77-5/8"		A-Series				PT: platinum*
89: 88-5/8"		SD: Advance Step Dim				BZ: bronze
						PR: primer
						CF: consult factory for custom color

\* A standard finish requiring a 2 step coating process, premium may apply

MOUNTING

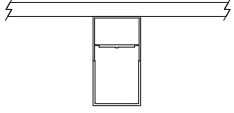
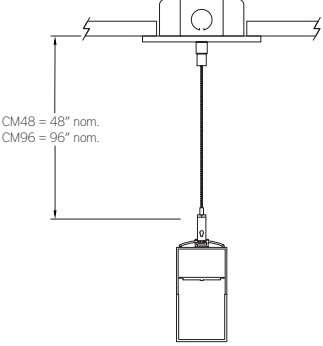
	ORDERING CODE	DESCRIPTION
	SM	<p>SURFACE MOUNT</p> <p>Use appropriate fastener through Ø3/16" holes in housing</p>
	CM48 and CM96	<p>CABLE MOUNT</p> <p>Mounting option includes:</p> <ul style="list-style-type: none"> <li>• Extruded aluminum cable hangers (can be located anywhere along fixture length)</li> <li>• Ø 1/16" x 48" (CM48) or 96" (CM96) aircraft cables</li> <li>• 18 gauge x 60" (CM48) or 102" (CM96) SJT power cable (in coordinating finish)</li> <li>• Bracket bars</li> <li>• Ø 5" white canopies</li> <li>• Ceiling couplers</li> <li>• Side exit cable grippers</li> </ul>