



BFL297

type:

LINEAR T5 FLUORESCENT

remote ballast T5 fluorescent fixture

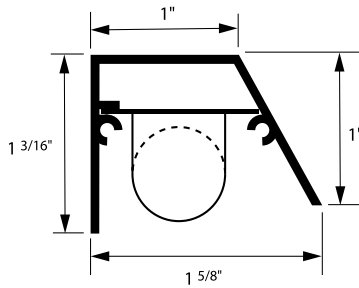

- SPECIFICATIONS |**
- Extruded aluminum housing available in anodized polished chrome, satin aluminum and polished brass finish (consult factory for custom finishes)
 - Steel linear/wireway finished in high reflectance white powder coat
 - All fixtures made to specified length $\pm 1/16"$
 - Rotational locking lamp holders
 - Installed end feed connector accepts $3/8"$ steel flex conduit (consult factory)
 - Optional $1/2"$ D x 36" aluminum down tube feed available in matching finishes
 - Wired with 12' leads for instant start ballast operation
 - Mounting accomplished with fasteners (by others) through aluminum housing or with optional end caps, FF3 stem mount kit or clips (for glass top to front display cases)
 - Available for T5 8W, 13W, 14W, 21W, 28W, 35W and high output 24W, 39W, 54W, 80W linear fluorescent lamp in single and tandem lamp models
 - UL and ULC listed for dry and damp locations
 - Requires a remote ballast and enclosure (ordered separately)
 - IBEW manufactured and labeled
 - Made in the U.S.A.

NOTE: Lamp holders are wired for instant start ballasts. For rapid start wiring, add suffix "/RS" to catalog number.

SPECIFICATION / ORDER FORMAT				DIMENSIONAL INFO.	
model no.	finish	*feed location	options	lamp	*fixture length range
BFL297-8	/CH - polished chrome	/CL - customer left	/RS - rapid start	8w T5	13-5/8" - 22-5/8"
BFL297-13	/SA - satin aluminum	/CR - customer right	(required for program start ballasts)	13w T5	22-11/16" - 23-7/8"
BFL297-14	/BR - polished brass	*customer point of view	/DL - damp location	14w T5	23-15/16" - 35-11/16"
BFL297-21	/CU - custom finish			21w T5	35-3/4" - 47-7/16"
BFL297-28	(consult factory)			28w T5	47-1/2" - 59-5/16"
BFL297-35				35w T5	59-3/8" +
BFL297-24				24w T5 HO	23-15/16" - 35-11/16"
BFL297-39				39w T5 HO	35-3/4" - 47-7/16"
BFL297-54				54w T5 HO	47-1/2" - 59-5/16"
BFL297-80				80w T5 HO	59-3/8" +

*specify to the nearest 1/16"

TUBE GUARD |

TG Tube Guard (sold by the foot) ___ft.

DOWNTUBE FEED | See display technical section for details

FF1 Downtube feed components
 FF3 Stem mount feed components

MOUNTING CLIP |

MC97 Fixture mounting clip (for glass to glass case mounting)
NOTE: Two to three required per fixture

END CAPS |

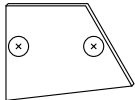

EC971 Pair solid end caps (for glass end cases)
 (screws to BFL297 housing)

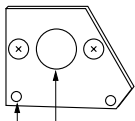

EC972 Pair end caps w/ drop mounting holes (for wood end case mounting)
 (screws to BFL297 housing)

1/2" Feed Hole
 1/8" Mounting Hole

display LIGHTING T5

05.2011