



2013 PRODUCT GUIDE

EVERY VISION BEGINS WITH INSPIRATION

GET INSPIRED WITHIN

BARTCO LIGHTING
5761 Research Drive
Huntington Beach, CA
92649

714.230.3200
bartcoLIGHTING.com



T5 Fluorescent
Page 6

T6 Fluorescent
Page 20

T8 Fluorescent
Page 24

L.E.D.
Page 36

Additional Sources
Page 42

T5

T6

T8

LED

ADDITIONAL SOURCES









Brightcove Headquarters

Boston, MA

BC7440 - custom T5 installation

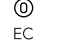
lighting design: Lam Partners
architect: Elkus Manfredi
photography: Japser Sanidad

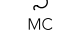
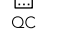
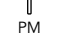
ACCESSORIES

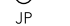
- | | | | | | |
|---|-------------------|--|-----------------------------------|---|-----------------------------------|
|  REF | REFLECTORS |  FF | DOWNTUBE FEED/ STEM MOUNT FEED |  BAC | AIR CRAFT CABLE SUSPENSION KIT |
|  LNS | LENSES |  EC | END CAP |  BAM | ARM MOUNT KIT |
|  MC | MOUNTING CLIPS |  QC | PLUG & PLAY QUICK CONNECT |  PM | PENDANT MOUNT |
|  TG | TUBE GUARD |  JP | JP QUICK CONNECT | | |

OPTIONS

- /DIM** - dimming (consult factory for power supply section on the website)
- /EB** - emergency ballast (consult factory)
- /CU** - custom finish - available in powdercoat or anodized (consult factory)
- /CB** - clean body housing (consult factory for knock-out locations)



T5 FLUORESCENT: THE STAPLE

From our inception, we've been introducing firsts to the market. We were among those front and center advancing the T5 movement, and we haven't looked back. The T5 linear fluorescent lamp remains one of the most versatile light sources, balancing color temperature accuracy, energy consumption, and light quality. From our MiT5 through our Flip and Slide and our Element Collection™, you won't be disappointed in our luminaires designed to maximize the advantageous qualities of this light source.

General Fixture Features:

Welded 20 gauge steel, extruded aluminum housing, fully assembled and pre-wired, post production powder coat or anodized finish, dry and damp listed, specialty fasteners/hardware, acrylic and polycarbonate elements, UL and ULC listed, IBEW Local Union 1710, Made in the USA

*Consult factory for specific fixtures



Staggered



BFL270-S



Our innovative adjustable stagger fixtures help eliminate socket shadows in demanding indirect lighting features. The single row Flip and Slide and the double row Slide by Side models are field adjustable to allow fine tuning for each application.

**Also available in T8 (p.27) or with LED (p.41). Consult factory for LED option.

integral ballast - 120 -277V & dimming ballasts

| flip and slide | potent no. US 6,431,726 B1 | flip and slide | slide by side |
|--|--|---|---|
| <p>BFLFS-T5</p> <p>options /DIM, /EB, /CU accessories LNS TG</p> | <p>BFL281-S</p> <p>options /DIM, /EB, /CU accessories LNS TG</p> | <p>BFL282-S</p> <p>options /DIM, /EB, /CU accessories LNS TG QC JP</p> | <p>BFL128</p> <p>options /CU accessories TG (interlocking staggered strip)</p> |
| <p>BFL270-S</p> <p>options /CU accessories TG remote ballast (ballast ordered seperately)</p> | <p>BFL272-S</p> <p>options /CU accessories TG remote ballast (ballast ordered seperately)</p> | <p>BFLSLM</p> <p>options /CU accessories LNS TG</p> | <p>BDS550</p> <p>options /DIM, /EB, /CU accessories TG</p> |



BFLFS-T5
demonstrating how the fixture flips open and slides to adjust lamp stagger distance



BFL282-S
demonstrating how the fixture slides to adjust lamp stagger distance

Flip and Slide
two fixtures shown joined together with adjustable stagger length

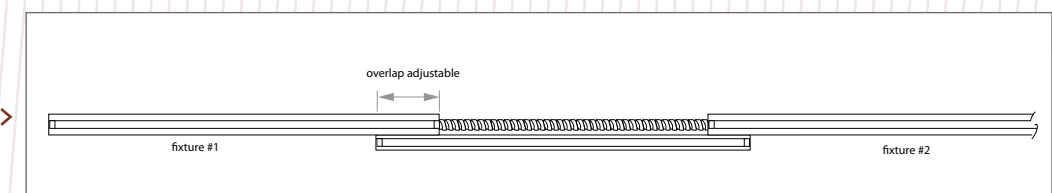

Karla Flower Shop
Headquarters
Miami, FL

BFL281-S - backlighting

architect: Rene Gonzalez Architect
photography: Ken Hayden Photography



1801K
Washington, D.C.

BFL270 & BFL281 - backlighting

lighting design: George Sexton
Associates
developer: Somerset Partners, LLC
photography: ©Dan Poyourow

Strips



MiT5 patent no US 6,652,119 B1



Our specification grade T5 fixtures are available in a variety of low profile sizes for applications where small-scale, feature packed lighting is required. These versatile fixtures are ideal for direct, indirect, backlight, utility, and creative display applications. Many T5 fixtures include our patented Lever Pivot Safety Socket (LPSS) to aid proper lamping and simplify lamp maintenance.

**Also available in T8 (p.29) or with LED (p.41). Consult factory for LED option.

remote ballast (ballast ordered separately)

integral ballast - 120 -277V & dimming ballasts

BFL270

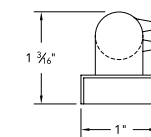

options /CU
accessories REF | LNS | TG

BFL272

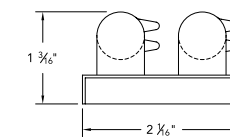

options /CU
accessories REF | TG

BFLSA

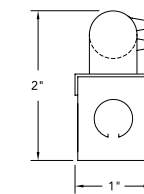

options /CU
accessories REF | LNS | MC | TG
QC | JP | BAC

BFLSAM

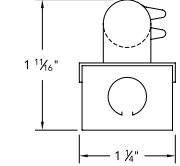

options /CU
accessories REF | LNS | MC | TG
QC | JP | BAC

MiT5 - IT patent no US 6,652,119 B1

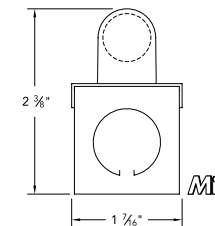

options /DIM, /EB, /CU, /CB
accessories REF | LNS | TG | QC | JP | BAC

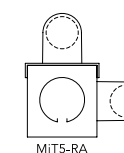
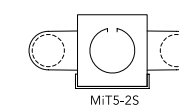
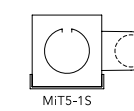

BFL281

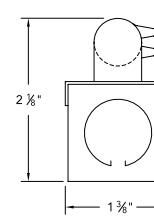

options /DIM, /CU, /CB
accessories REF | LNS | MC | TG
QC | JP | BAC

BFL282

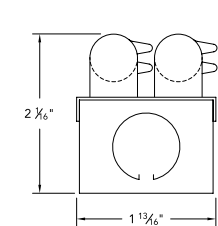

options /CU
accessories REF | TG | QC | JP | BAC

slide a light patent no. US 8,152,331

BFL110

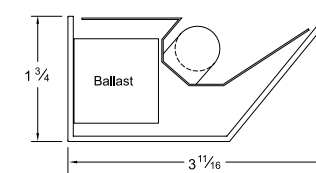

options /DIM, /EB, /CU
accessories TG | QC

BFL206

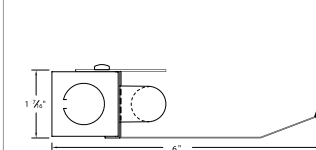

options /DIM, /EB, /CU
accessories TG | QC | JP

BFL207

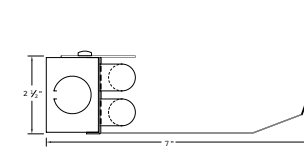

options /DIM, /EB, /CU
accessories TG | QC | JP

RSL5

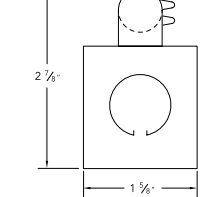

options /DIM



◀ **Lever Pivot Safety Socket**
(LPSS) patent no. US7,097,327 B1
note: cannot be used with LNS accessory
on 2 lamp fixtures

BFLSAM-JP
with JP Quick Connect





AllWeather™



BW5



With an IP-65 rating, our ALL WEATHER™ line has been tested to standards more stringent than a UL wet listing. The line is protected from low-pressure jets of liquid from all directions, as well as dust and other solids. It comes standard with a clear tube guard and an electronic ballast capable of starting in temperatures as low as 0°F.

** Also available in T8 (p.27).

integral ballast - 120 -277V & dimming ballasts

BW5

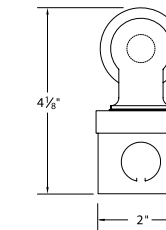

options /DIM, /CU

BW5-S

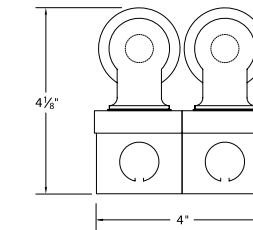

options /DIM, /CU

BAM



BAM arm



Our BAM series developed out of a design requirement for a specific project. This is an example of our capability to take a “display” fixture and transform it into an up light, wall wash, or task light. Three mounting systems are available for several of our standard luminaires. Utilizations of the BAM series may require factory consultation.

**Also available in T8 (p.31) or with LED (p.39). Consult factory for LED option.

BAM290

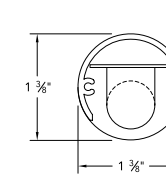

options /CU
accessories LNS | TG

remote ballast (ballast ordered seperately)

BAM292

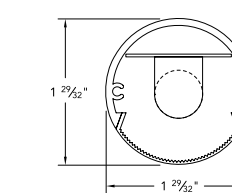

options /CU
accessories LNS | TG

remote ballast (ballast ordered seperately)

Seattle Central
Library
Seattle, WA

BAM292 - task lighting

lighting designer: Kugler Tillotson Associates
architect: OMA/LMN
photography: Lara Swimmer Photography



Walden Residence

ZAG - ambient lighting

lighting design: Derek Porter Studio
 photography: DPS

BT5



BT5100



The T5 Seamless fluorescent lamp is designed to minimize the dark areas of light associated with traditional linear sources in cove lighting. Other applications that can benefit from this lamp include indirect installations with tight confines and shallow light boxes. The BT5100 and IPR55-T5S architectural fixture allow for very close end-to-end lamp mounting and are available with standard or high output T5 Seamless lamps in normal lengths of 2' - 4'.

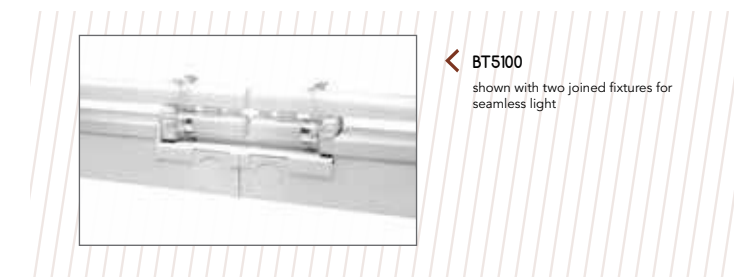
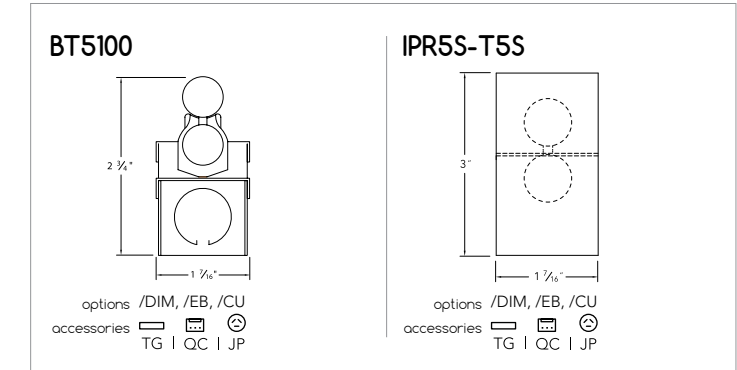

STUDIO by Bartco™

ZAG



We developed STUDIO by Bartco™ to explore new and unprecedented approaches toward conventional fluorescent strip design. The line reimagines the iconic luminaire as an expressive design instrument within a contemporary interior space. ZAG is a modular fixture that traverses open space, creating dramatic linear patterns between walls, floor, or ceiling surfaces.

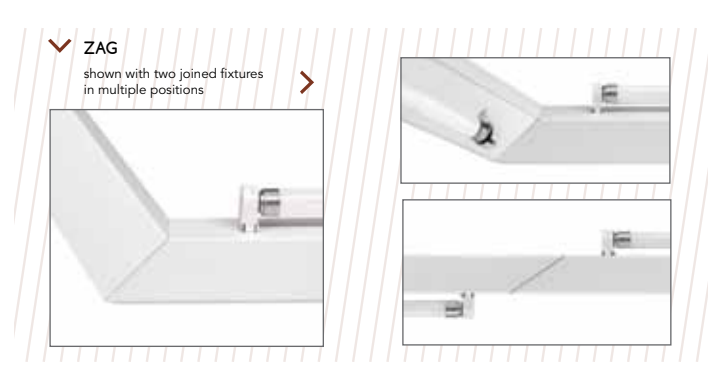
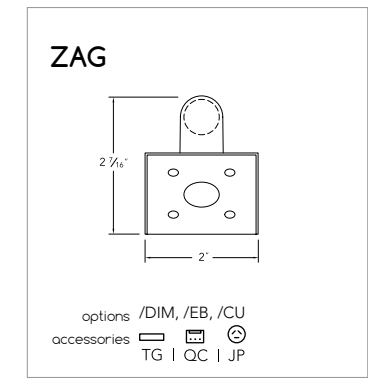



Wilshire Blvd
HighRise Condo
Los Angeles, CA

IST8R - vanity lighting

lighting design: Light Engine
photography: David Komonosky

Elytron Collection™



IST5R



Function and Form: that's what defines our Elytron Collection™ line of luminaires. It offers an attractive aesthetic while delivering protective, stylized end caps to eliminate dark spots normally attributed to the socket ends of the light source. Presenting a multitude of options, the line is available in surface mount, aircraft cable suspended, or pendent mount versions.

**Also available in T8 (p.33) or with LED (p.39). Consult factory for LED option.

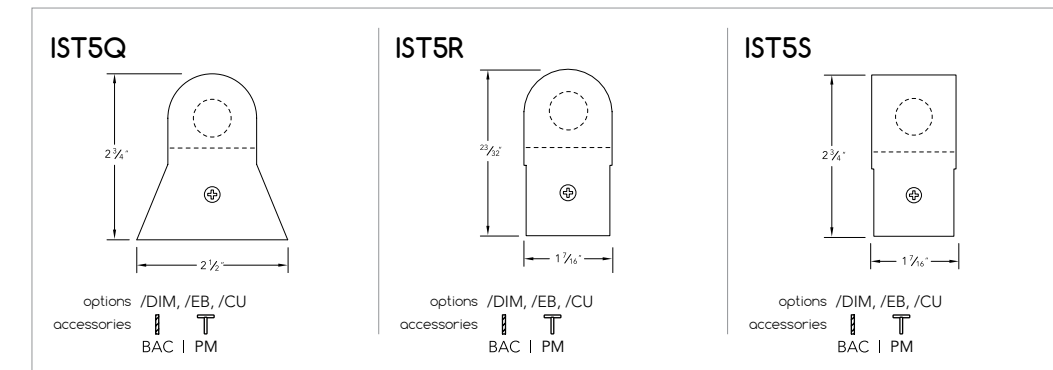

Essence Collection™



IPR5S



Stripping the linear fluorescent fixture down to the basics, the Essence Collection™ line of luminaires boasts a streamlined, minimalistic design. With its extremely small footprint at the end detail and variety of finishes, these luminaires are available for surface mount, aircraft cable suspension, or pendent mount applications.

**Also available in T8 (p.33) or with LED (p.41). Consult factory for LED option.

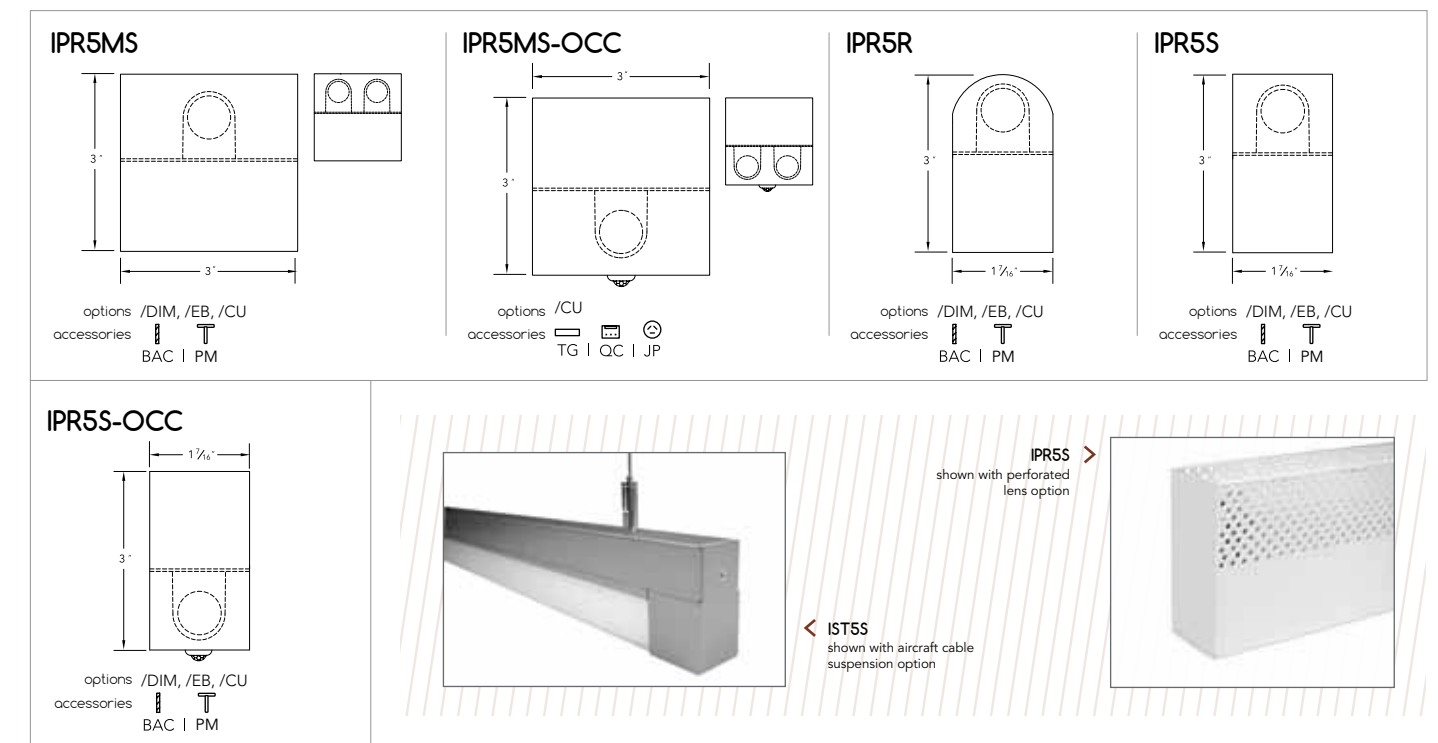



NREL Cafeteria
Golden, CO

IEL5R - suspended lighting

architect: RNL Design
photography: Frank Ooms©2011

Element Collection™



IEL5R



The design for the Element Collection™ was achieved by reducing the standard fluorescent strip to its most basic components (ballast, lamp, and socket), revealing a luminaire of simple geometric shapes ideal for exposed lamp, decorative installations.

**Also available in T8 (p.35) or with LED (p.41). Consult factory for LED option.

IEL5R

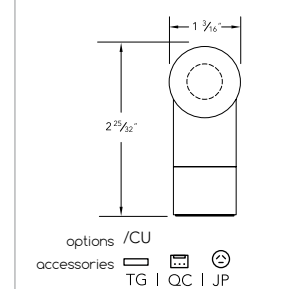

IEL5C

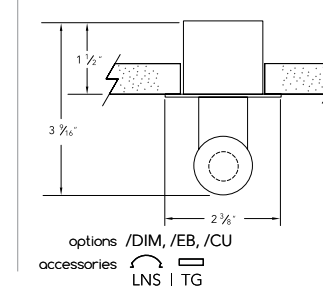

IEL5H

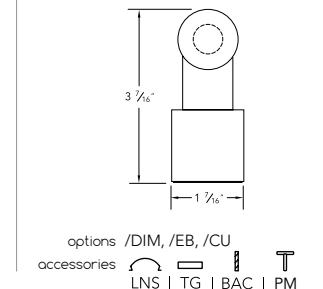

IEL5S

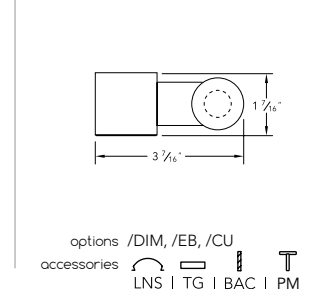

IEL5DS

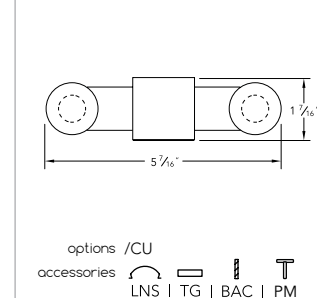

IEL5DS
double T5 lamp. All accessories available



IEL5H
shown with perforated lens accessory



IEL5R
shown with blade lower accessory

Task / Display



BFL293



We offer a variety of fixtures designed to focus light where it is needed; be it on a work surface or retail merchandise. Our task lighting are available with on/off switches and most incorporate our exclusive Lever Pivot Safety Socket (LPSS). Some models also accommodate passive infrared (occupancy) sensors for increased control. Our low profile, extruded display light fixtures provide a subtle, decorative element for many merchandising needs, such as display case lighting.

**Also available in T8 (p.31) or with LED (p.41). Consult factory for LED option.

BC7502

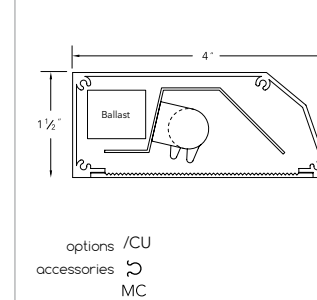

BFL293

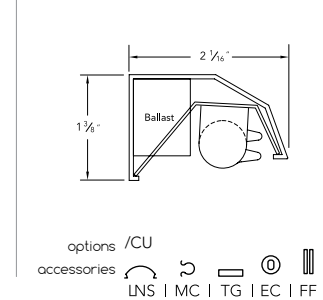

MiT5-1S-UC-OCC

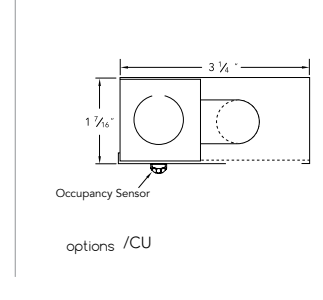

BFL297

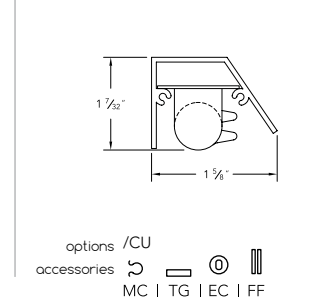

remote ballast (ballast ordered separately)



T6 FLUORESCENT: THE BEAUTY

It's sleek...it's elegant...it's simplicity...and it's beautiful. The T6 linear fluorescent lamp also solves a basic linear fluorescent need; continuous, shadow-free illumination. With seven color temperatures available in five lengths, the T6 lamp offers unmatched variety and design flexibility for a fluorescent source. We have created a vast luminaire line to optimize the light source in cove applications through exposed lamp vanity installations.

General Fixture Features:
Welded 20 gauge steel, housing, fully assembled and pre-wired, post production powder coat, dry and damp listed, specialty fasteners/hardware, acrylic elements and UL and ULC listed, IBEW Local Union 1710, Made in the USA

*Consult factory for specific fixtures

Parrish Art Museum
Water Mill, NY

BC245 - custom T6 surface
mounted lighting

architect: Herzog & de Meuron
photography: ©Roland Halbe 2012



BT6



BT6100



Our BT6 product family utilizes an exclusive T6 linear fluorescent lamp. The unique design allows the ability to place lamps closely, enabling greater lumen consistency in continuous runs. The BT6 designs range from fundamental architectural strips to refined contemporary luminaires that emphasize the elegant shape and scale of the distinctive light source.

BT6105

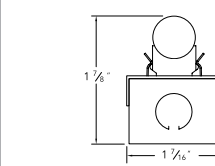

options /CU
accessories REF | LNS

BT6100

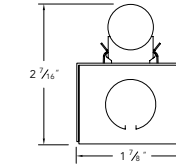

options /DIM, /EB, /CU
accessories REF | LNS

BT6110

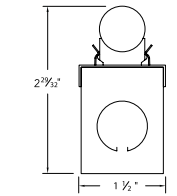

options /DIM, /EB, /CU
accessories REF | LNS

BT6115

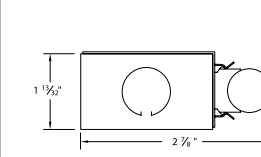

options /DIM, /EB, /CU
accessories REF | LNS

BT6200

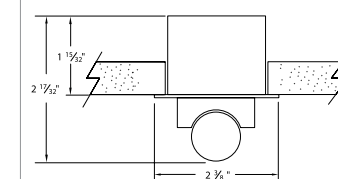

options /DIM, /EB, /CU

BT6300

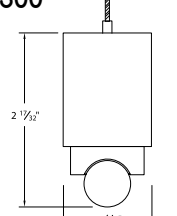

options /DIM, /EB, /CU
accessories REF

BT6400

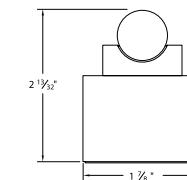

options /DIM, /EB, /CU
accessories REF

BT6405

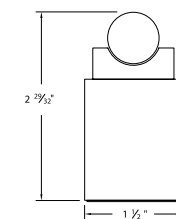

options /DIM, /EB, /CU
accessories REF



BT6400
shown with two joined fixtures for seamless light



BT6200
fixture shown with semi-recessed option

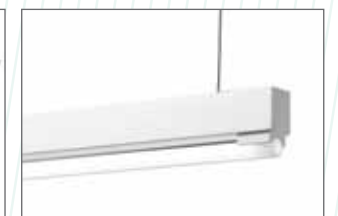

BT6300
fixture shown with aircraft cable option



T8 FLUORESCENT: THE STANDARD

Even with the rapid adoption of solid state lighting in the marketplace, the venerable linear T8 lamp remains a value powerhouse. With many lamps offering low wattage options and greater than 40,000 hours of life, the T8 remains a go-to source for many applications. Naturally, we have developed dozens of luminaires over the years for the T8 lamp to cover most any lighting need. We cover everything from indirect lighting with our products like our Slide by Side to clean, contemporary aesthetics with our sleek Essence Collection™.

General Fixture Features:

Welded 20 gauge steel, extruded aluminum housing, fully assembled and pre-wired, post production powder coat or anodized finish, dry and damp listed, specialty fasteners/hardware, acrylic and polycarbonate elements, UL and ULC listed, IBEW Local Union 1710, Made in the USA

*Consult factory for specific fixtures



Confidential Company

MiT5 - interior surface mounted lighting

architect: Perkins + Will
 photography: Michelle Litvin,
 Design by Perkins + Will

Staggered



BFL254-S



Achieving shadow-free indirect illumination in tight spaces is much easier to achieve with our broad array of staggered fixtures. Fixed stagger models include an ultra low profile, remote ballast design and integral ballast, diagonal stagger luminaire. For added flexibility, we also offer our exclusive, field adjustable Slide by Side and Flip and Slide models for 2' through 5' T8 lamps.

**Also available in T5 (p.9) or with LED (p.41). Consult factory for LED option.

integral ballast - 120-277V & dimming ballasts

| flip and slide patent no. US 6,431,726 B1 | flip and slide | slide by side | slide by side |
|--|--|--|--|
| <p>BFLFS-T8</p> <p>options /DIM, /EB, /CU accessories LNS TG</p> | <p>BFL255-S</p> <p>options /DIM, /EB, /CU accessories LNS TG</p> | <p>BFL254-S</p> <p>options /DIM, /EB, /CU accessories TG QC JP</p> | <p>BFL257-S</p> <p>options /DIM, /EB, /CU accessories TG QC JP</p> |
| <p>BDS850</p> <p>options /CU accessories TG</p> | <p>BFL250-S</p> <p>options /CU accessories TG</p> <p>remote ballast (ballast ordered separately)</p> | <p>▲ BFLFS-T8 demonstrating how the fixture flips open and slides to adjust lamp stagger distance</p> <p>▼ BDS850 shown with two single lamp interlocking fixtures</p> | |

AllWeather™



BW8



With an IP-65 rating, our ALL WEATHER™ line has been tested to standards more stringent than a UL listing. The line is protected from low-pressure jets of liquid from all directions, as well as dust and other solids. It comes standard with a clear tube guard and an electronic ballast capable of starting in temperatures as low as 0° F.

** Also available in T5 (p.13)

integral ballast - 120-277V & dimming ballasts

| | |
|--|--|
| <p>BW8</p> <p>options /DIM, /CU</p> | <p>BW8-S</p> <p>options /DIM, /CU</p> |
|--|--|



Solestruck
Portland, OR

MiT8 & BFL257

lighting design: Biella Lighting
architect: Skylab Architecture
photography: Boone Speed

Strips



BFL252



Our T8 fixtures are minimal profiled and manufactured in a variety of styles to meet the needs of most applications. This industry staple light source is offered in single, double, and multi-lamp configurations and is available with remote or integrally ballasted fixture designs.

**Also available in T5 (p.11) or with LED (p.41). Consult factory for LED option.

remote ballast (ballast ordered separately)

integral ballast - 120 -277V & dimming ballasts

BFL250

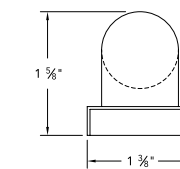

options /CU
accessories REF | LNS | TG

BFL252

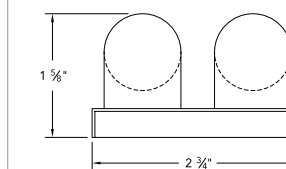

options /CU
accessories REF | TG

BFL208

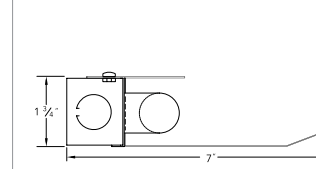

options /DIM, /EB, /CU
accessories TG | QC | JP

BFL209

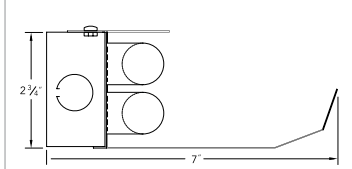

options /DIM, /EB, /CU
accessories TG | QC | JP

MiT8-IT

patent no US 6,652,119 B1

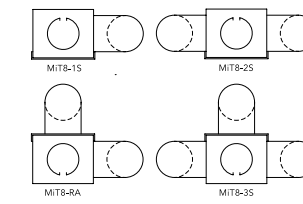
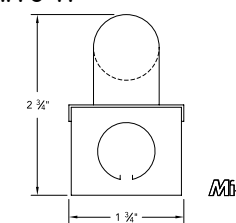

options /DIM, /EB, /CU, /CB
accessories REF | LNS | TG | QC | JP | BAC

BFL800-IT

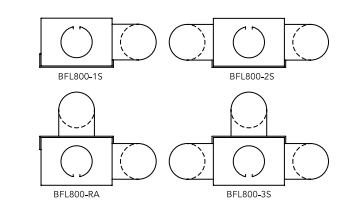
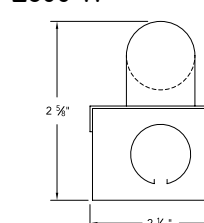

options /DIM, /EB, /CU, /CB
accessories REF | LNS | TG | QC | JP | BAC

BFLBA-IT

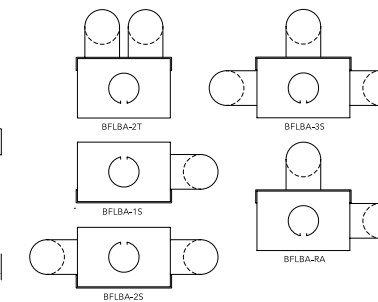
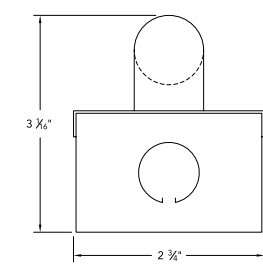

options /DIM, /EB, /CU, /CB
accessories REF | LNS | TG | QC | JP | BAC

BFL255

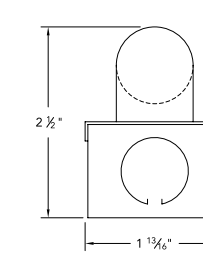

options /DIM, /EB, /CU, /CB
accessories REF | LNS | MC | TG
QC | JP | BAC

BFL257

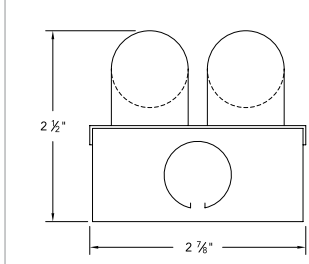

options /DIM, /EB, /CU, /CB
accessories REF | TG | QC | JP | BAC
(interlocking single lamp diagonal stagger)



◀ **MiT8-IT**
with universal clear fine prismatic and frosted acrylic lens accessories



BFL208 >
fixture shown with standard sawtooth reflector



BAM



BAM arm



Our BAM series developed out of a design requirement for a specific project. This is an example of our capability to take a "display" fixture and transform it into an up light, wall wash, or task light. Three mounting systems are available for several of our standard luminaires. Utilizations of the BAM series may require factory consultation.

****Also available in T5 (p.13) or with LED (p.41). Consult factory for LED option.**

BAM917

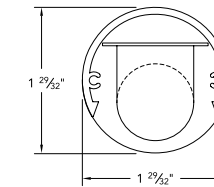

options /CU
accessories LNS | TG

remote ballast (ballast ordered separately)

BAM900

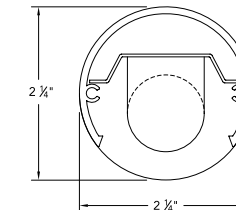

options /CU
accessories LNS | TG

remote ballast (ballast ordered separately)

Task/Display



BFL100



We offer a variety of fixtures designed to focus light where it is needed; be it on a work surface or retail merchandise. Our low profile T8 task light, incorporates a passive infrared (occupancy) sensor, multiple lens options and is available in a wide variety of standard powder coat finishes. We also manufacture several sheet formed and extruded display light fixtures that provide a subtle, decorative element for many merchandising needs, such as display case lighting.

****Also available in T5 (p.19) or with LED (p.41). Consult factory for LED option.**

MiT8-1S-UC-OCC

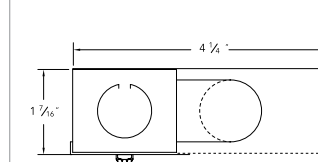

options /CU

BFL100

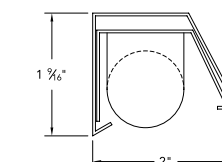

options /CU
accessories MC | TG | EC | FF

remote ballast (ballast ordered separately)

BFL300

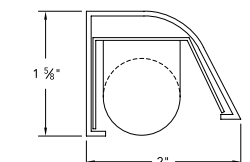

options /CU
accessories MC | TG | EC | FF

remote ballast (ballast ordered separately)

Cushing Center at Yale Medical School

New Haven, CT

BFL293 - undershelf display lighting

lighting design: Atelier Ten
architect: Turner Brooks Architects
photography: Tom Bonner Photography

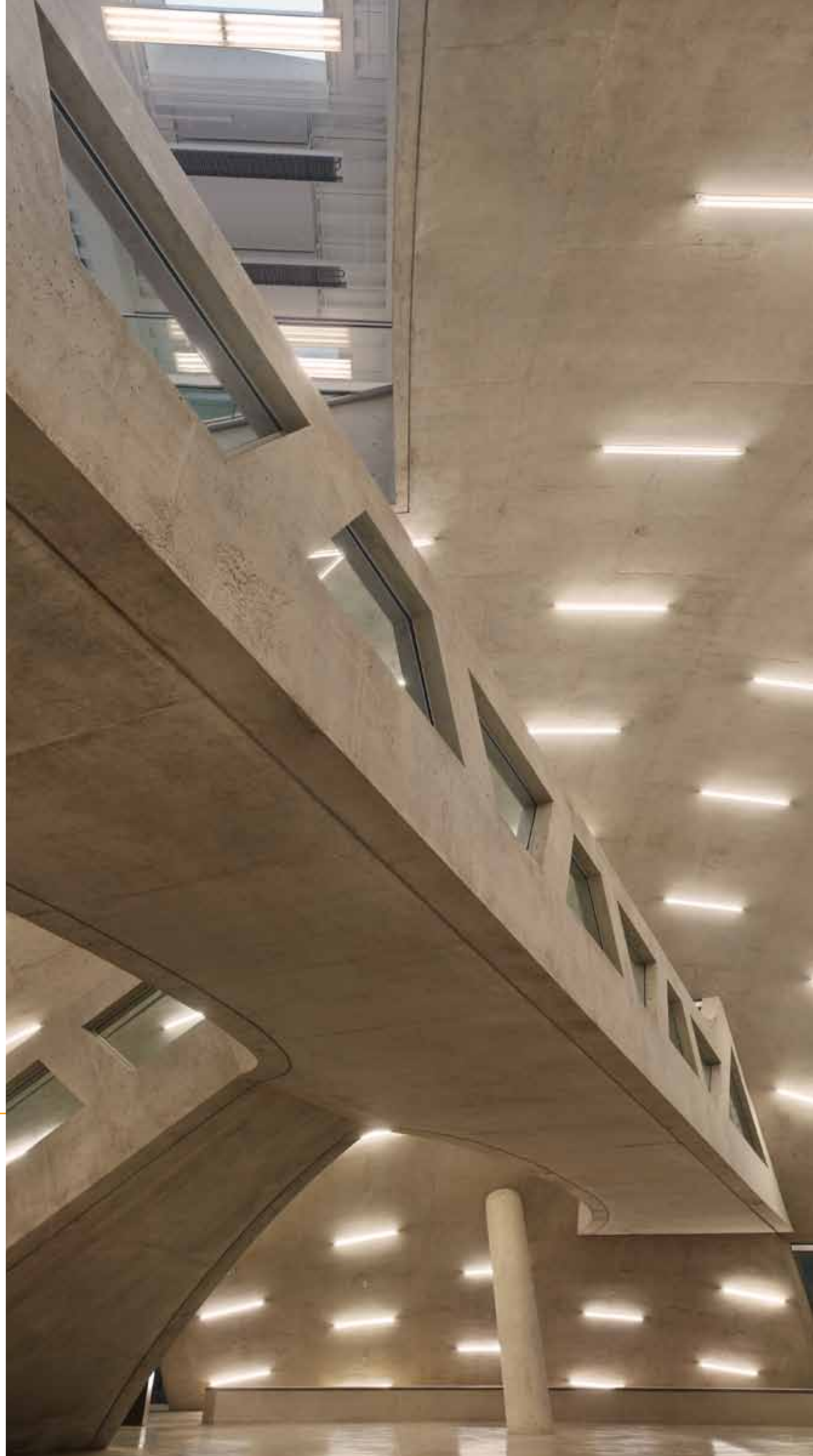

Milstein Hall
Ithaca, NY

BC7373 & BC147 -
semi recessed and
suspended lighting

lighting design: Office of Metropolitan
Architecture
photography: Brad Feinkopf ©2011

Elytron Collection™



IST8R



Function and Form: that's what defines our Elytron Collection™ line of luminaires. It offers an attractive aesthetic while delivering protective, stylized end caps to eliminate dark spots normally attributed to the socket ends of the light source. Presenting a multitude of options, the line is available in surface mount, aircraft cable suspended, or pendant mount versions.

**Also available in T5 (p.17) or with LED (p.41). Consult factory for LED option.

IST8Q

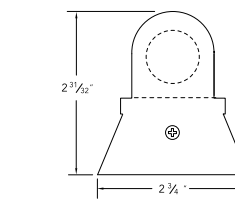

options /DIM, /EB, /CU
accessories I T
BAC | PM

IST8R

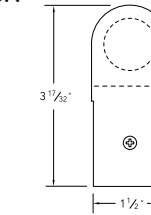

options /DIM, /EB, /CU
accessories I T
BAC | PM

IST8S

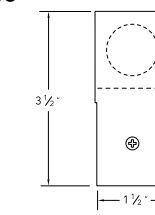

options /DIM, /EB, /CU
accessories I T
BAC | PM

Essence Collection™



IPR8S



Stripping the linear fluorescent fixture down to the basics, the Essence Collection™ line of luminaires boasts a streamlined, minimalistic design. With its extremely small footprint at the end detail and variety of finishes, these luminaires are available for surface mount, aircraft cable suspension, or pendant mount applications.

**Also available in T5 (p.17) or with LED (p.41). Consult factory for LED option.

IPR8MS

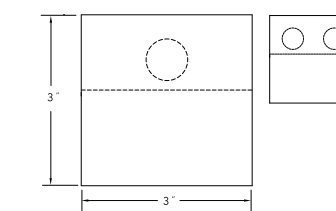

options /DIM, /EB, /CU
accessories I T
BAC | PM

IPR8MS-OCC

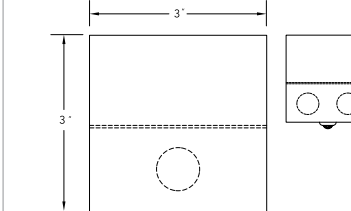

options /CU
accessories TG | QC | JP

IPR8R

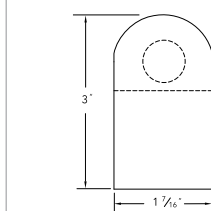

options /DIM, /EB, /CU
accessories I T
BAC | PM

IPR8S

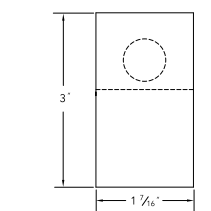

options /DIM, /EB, /CU
accessories I T
BAC | PM

IPR8S-OCC

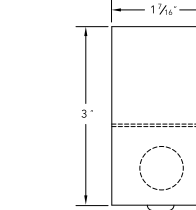

options /DIM, /EB, /CU
accessories I T
BAC | PM



< IPR8MS
shown in silver powdercoat

IST5S / IST8S >
shown with two joined fixtures

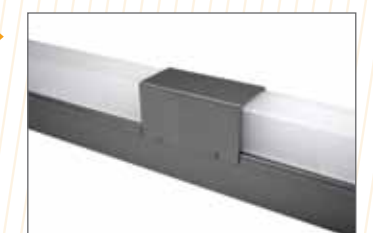



Element Collection



IEL8S



The design for the Element Collection™ was achieved by reducing the standard fluorescent strip to its most basic components (ballast, lamp, and socket), revealing a luminaire of simple geometric shapes ideal for exposed lamp, decorative installations.

**Also available in T5 (p.19) or with LED (p.41). Consult factory for LED option.

IEL8R

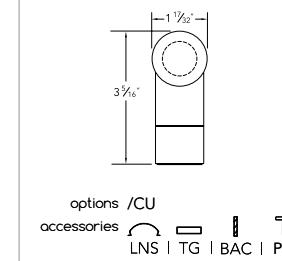

IEL8C

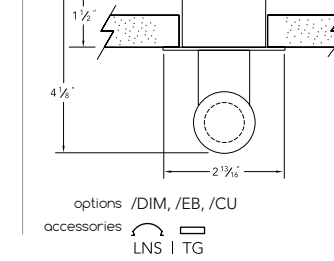

IEL8H

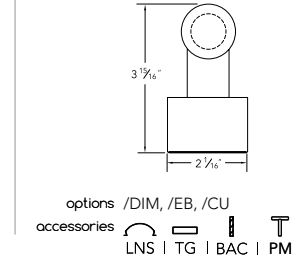

IEL8L

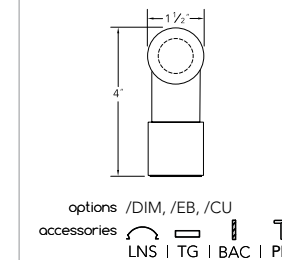

IEL8S

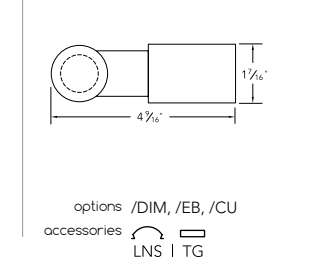

IEL8DS

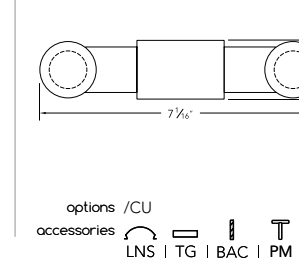

IEL8H shown with perforated lens accessory



IEL8DS double T8 lamp. All accessories available



IEL8R shown with blade louver accessory

Casey Kaplan Gallery
New York, NY

MiT8-2T

lighting design: Lighting Design Alliance
architect: NMDA/ Neil M. Denari Architects
photography: Adam Reich



LINEAR LED: THE PRESENT

As the lighting manufacturing industry quickly shifts to the new paradigm brought on by solid state lighting, we have been at the forefront, developing LED luminaires that meet the needs of today's lighting specifiers. As with our traditional light source products, our LED offerings are specification grade, made in the USA and backed by our solid reputation.

General Fixture Features:

Welded 20 gauge steel, extruded aluminum housing, fully assembled and pre-wired, post production powder coat or anodized finish, dry and damp listed, specialty fasteners/hardware, acrylic and polycarbonate elements, UL and ULC listed, IBEW Local Union 1710, Made in the USA

*Consult factory for specific fixtures



Bulgari
New York, NY

XLS8290 - stair lighting

lighting design: Lido
architect: Space4 Architecture
photography: Jody Kivort

LED



BSS300



Drawing on our vast experience in developing many successful luminaires for linear lighting, it is only logical that we would design our first generation of LED fixtures to address similar applications. We provide two basic solutions for linear solid state lighting. One, incorporate LED sources that match incumbent form factors, (such as linear T5), into our existing fluorescent-based models for general lighting and, two, design ground-up luminaires with circuits, construction and optics tailored to more specific tasks.

| | | | |
|--|--|---|---|
| <p>R10-270</p> <p>options /CU remote driver (driver ordered separately)</p> | <p>R10M-1T</p> <p>options /CU, /CB accessories MC BAC QC JP BAC (Includes R10 & Driver)</p> | <p>R10UC</p> <p>options /CU (includes R10 & Driver)</p> | <p>BSS300</p> <p>options /CU</p> |
| <p>XLS8290</p> <p>options /CU accessories MC BAC BAM (LED fixture with standard flat lens.)</p> | <p>XLS8400</p> <p>options /CU accessories MC BAC BAM (LED fixture with standard flat lens.)</p> | <p>BAM-XLS8290</p> <p>options /CU (LED fixture with standard flat lens.)</p> | <p>BAM-XLS8400</p> <p>options /CU (LED fixture with standard flat lens.)</p> |
| <p>BSS110</p> <p>options /DIM, /CU</p> | <p>ADL200</p> <p>options /DIM</p> | <p>BSS210</p> <p>options accessories BAC PM</p> | <p>ECO5-JP</p> <p>(This item only available with 120V)</p> |

closet rod

BCR100

options /CU
remote driver (driver ordered separately)



BSS110
cove LED fixture

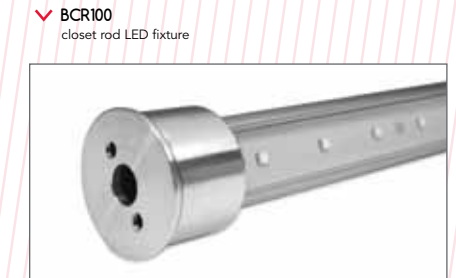

BCR100
closet rod LED fixture





LED Retrofit



Bartco Lighting makes it simple to incorporate LED lighting into an application with any one of our fluorescent retrofit options.

Our exclusive Eco5 T5 replacement LED lamp wires directly with 120V (no external driver required) and is UL Classified for use in existing luminaires. It is available in five standard color temperatures (2700K – 5000K), in nominal 1'-5' lengths.

For universal voltage flexibility and dimming ability, look to our unique high brightness R10 LED lamp and low profile driver. This component duo is UL recognized for use in our T5 fluorescent-based luminaires.

ECO5



(This item only available with 120V)

ECO8



R10 & Driver



Rock and Roll
Hall of Fame
Cleveland, OH

R10M-1T

lighting design: Fisher Marantz Renfro Stone
architect: I.M. Pei

LED



ADDITIONAL SOURCES

ADDITIONAL SOURCES

We recognize that many lighting tasks call for sources that do not take the shape of a long tube. Enter the compact fluorescent lamp. Their short lengths and high lumen outputs provide a great solution for small spaces and organic architectural features.

General Fixture Features:

Welded 20 gauge steel housing, fully assembled and pre-wired, post production powder coat or anodized finish, dry and damp listed, specialty fasteners/hardware, UL and ULC listed, IBEW Local Union 1710, Made in the USA

*Consult factory for specific fixtures



CFL



BFL255-PL-L



When a lighting application calls for illumination to highlight curvilinear lines or shapes we have products to satisfy the need. We provide a luminaire solution in the form of remote and integral ballast models that accept T4 quad compacts and T5 twin tube lamps. These sturdy, modular fixtures can be had with a variety of reflector accessories.

BFL255-PL-L

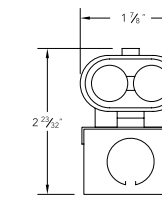

options /EB, /CU

BFL255-PL-C

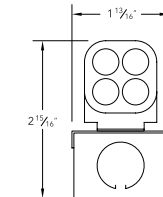

options /EB, /CU

BFL250-PL-L

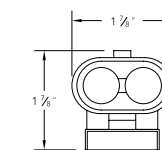

options /CU

BFL250-PL-C

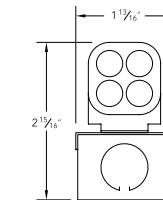

options /CU

Private Residence

BFL255-PL-C

lighting design: Kathy Pryzgoda

INSPIRATIONS



K-Station

Portland, OR

BC7373 & BC7364

lighting design: Ella Mills, Biella Lighting Design
photography: ©2012 JOSH PARTEE





University of Iowa
Iowa City, IA

Various Fixtures

architect: Steven Hall Architects
photography: Andy Ryan





New Museum of Contemporary Art
New York, NY

Various Fixtures

lighting design: Tillotson Design Associates
architect: Sanaa
photography: Dean Kaufman





Barclay's Center
Brooklyn, NY

BT6200

lighting design: Goldstick Lighting Design
architect: Ellerbe Becket



Jimmy Green Bar & Grill
Chicago, IL

BT6200 & BT6300

lighting design: DesignBridge
architect: DesignBridge
photography: DesignBridge

Aria Resort & Casino

Las Vegas, NV

BFL270, BFLS-T5, MiT5

architect: Pelli Clarke, Pelli Architects
photography: Courtesy of City Center Land, LLC



111 S. Wacker Drive

Chicago, IL

MiT8-IT

lighting design: Cosentini Lighting Design
architect: Goettsch Partners
photography: Steinkamp / Ballogg



Parrish Art Museum
Water Mill, NY

BC245

architect: Herzog & de Meuron
photography: ©Roland Halbe 2012

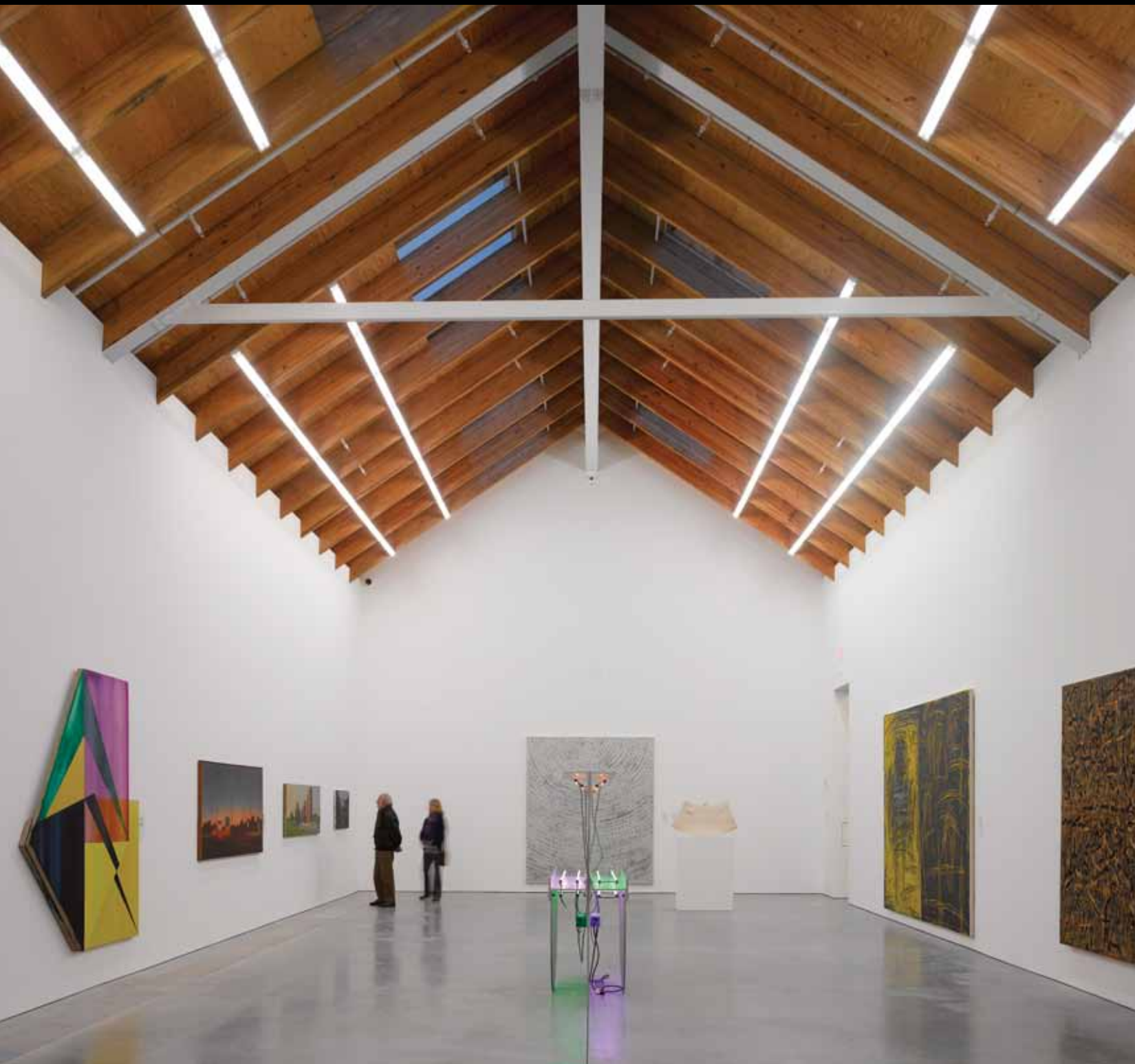

AT&T

Various locations

Mit5, BFLFS-T5, BFL128, BFL265

photography: ©2012 Callison/Chris Eden



Brightcove Headquarters

Boston, MA

BC7440 - custom T5 installation

lighting design: Lam Partners
architect: Elkus Manfredi
photography: Japser Sanidad



Lorry I. Lokey Stem Cell Research Center - Stanford University
Stanford, CA

BFL293 TL

lighting design: Jacob's Consultancy
architect: ZGF



American University of Beirut
Beirut, Lebanon

BAM292 & BC030

architect: VJAA & Samir Khairallah & Partners



Milstein Hall

Ithaca, NY

BC7373 & BC147 - semi recessed and suspended lighting

architect: Office of Metropolitan Architecture
photography: Brad Feinkopf ©2011



EVERY LEGACY BEGINS WITH VISION

VISIONS BROUGHT TO LIGHT

BARTCO LIGHTING
visions brought to light

5761 Research Drive
Huntington Beach, CA 92649

714.230.3200
bartcoLIGHTING.com

© 2013 Bartco Lighting, Inc. All Rights Reserved. This catalog is intended to be a guide. Please consult website cutsheets or the factory for specifics. The products in this catalog are protected by patents and patents pending. No reuse or reproduction of photographs, drawings, or copy is allowed. Bartco Lighting reserves the right to discontinue or to change design or technical specifications of any product at any time without notification. All lamps must be ordered/specified separately. Not all fixtures can be used with all light sources. Elytron Collection, Essence Collection, Element Collection, BAM, MIT5, MIT8, All Weather, BT6, BT5, STUDIO by bartco, ECO5, ECO8, and R10 are trademarks of Bartco Lighting, Inc.





bartcoLIGHTING.com | 714.320.2300 | 5761 Research Drive Huntington Beach, CA 92649